

NOTE: ALL LEGAL RECORDS, ENCUMBRANCES AND UTILITIES INDICATED OR REPRESENTED BY THIS DRAWING ARE OWNED BY AND ARE THE PROPERTY OF THE CITY OF YONKERS. THE CONTRACTOR SHALL VERIFY AND BE RESPONSIBLE FOR ALL DIMENSIONS AND CONDITIONS ON THE JOB AND THE OFFICE MUST BE ADVISED OF ANY VARIATIONS FROM THE DRAWING AND CONDITIONS SHOWN BY THESE DRAWINGS. SHOP DETAILS MUST BE SUBMITTED TO THIS OFFICE FOR APPROVAL BEFORE PROCEEDING WITH FABRICATION.

LEGAL NOTICE: ALTERATIONS BY ANY PERSON IN ANY WAY OF ANY ITEM COMPARED TO THIS DOCUMENT, UNLESS ACTING UNDER THE DIRECTION OF THE LICENSED ARCHITECT WHOSE PROFESSIONAL SEAL IS AFFIXED HERETO, IS A VIOLATION OF TITLE 18, SECTION 205.13 OF NEW YORK STATE LAW.

© Copyright Kayser, Garment, & Davidson Architects.
 All rights reserved.

Professional Seal

No.	Date	Issue
4	11-01-2021	ISSUE FOR BID
3	07-14-21	CONST. DOCS - FOR NYSID
2	12-15-20	DESIGN DEVELOPMENT
1	08-31-20	SCHEMATIC DESIGN

WORK ZONE TRAFFIC CONTROLS - 4

Job No.	Date
2019-1026	06-24-21

Scale:	Drawn / Checked
AS NOTED	--

LEGEND

	EXISTING PROPERTY LINE
	EXISTING EDGE OF PAVEMENT
	EXISTING CURB
	EXISTING FENCE
	EXISTING SIGN
	EXISTING 5' CONTOUR
	EXISTING SPOT GRADE
	EXISTING UTILITY POLE WITH OVERHEAD WIRES
	EXISTING LIGHT POLES
	EXISTING UNDERGROUND COMMUNICATION LINE
	EXISTING UNDERGROUND TV LINE
	EXISTING UNDERGROUND GAS LINE
	EXISTING UNDERGROUND WATER LINE
	EXISTING WATER VALVE & HYDRANT
	EXISTING GAS VALVES
	EXISTING UNDERGROUND DRAINAGE LINE
	EXISTING DRAINAGE STRUCTURE
	PROPOSED 10' CONTOUR
	PROPOSED 1' CONTOUR
	PROPOSED SPOT ELEVATION

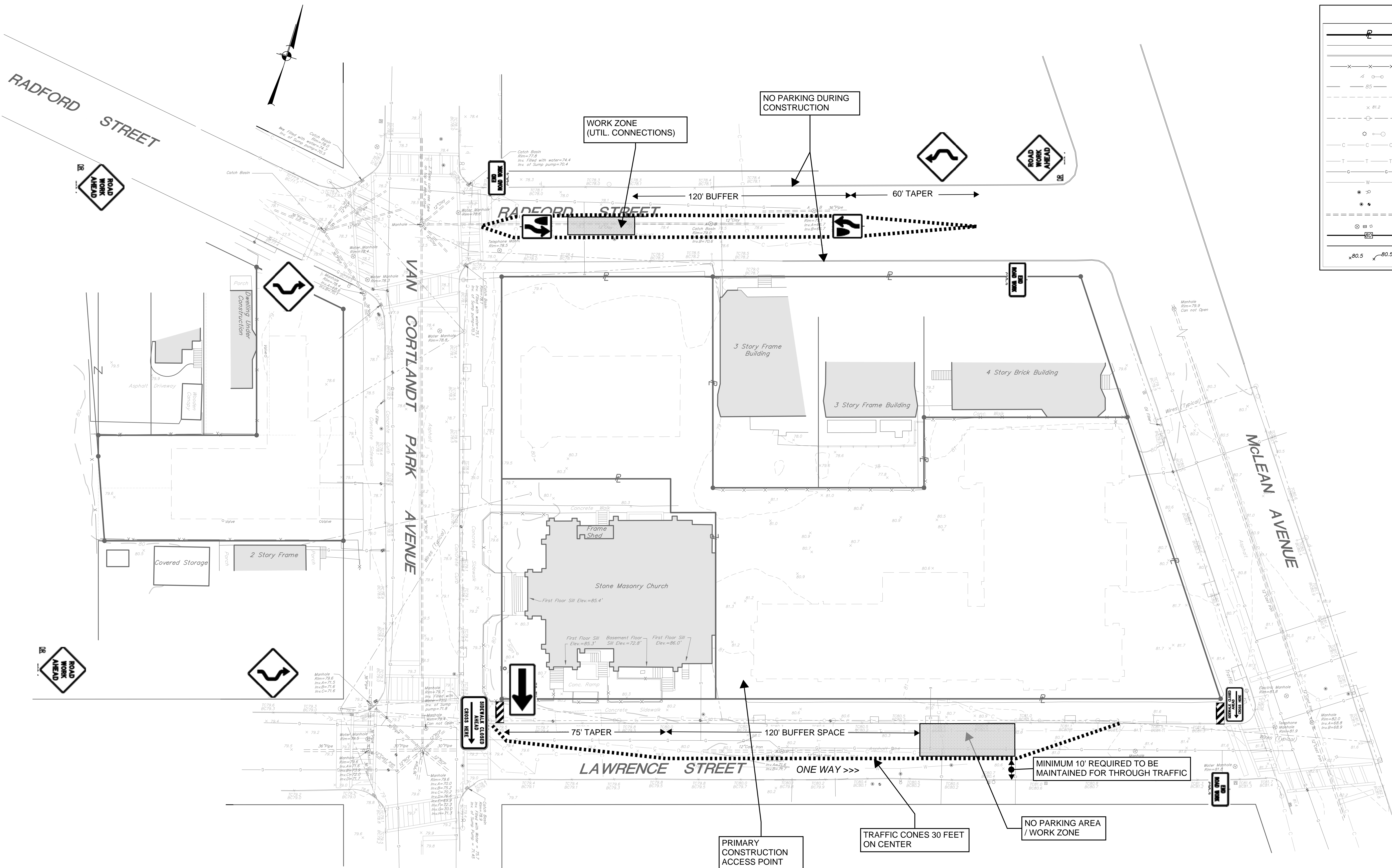

TRAFFIC CONTROL IN RADFORD STREET:

TRAFFIC CONTROL FOR WORK ZONE IN TRAVEL LANE - COMPLY WITH THE REQUIREMENTS OF NYS DOT STANDARD SHEET 619-64 FOR A CENTER OF ROAD CLOSURE SHIFT. CONE OFF PARKING SPACES AND POST TEMPORARY NO PARKING SIGNS AS NEEDED, BOTH SIDES OF ROAD.

REFER TO SHEETS T102, T103, T105 FOR WORK ZONE TRAFFIC CONTROLS ON RADFORD STREET INVOLVING OTHER LANE CLOSURE CONFIGURATIONS.

NOTES:

1. WHEN THE MINIMUM LANE WIDTH OF 10' CANNOT BE MAINTAINED DUE TO A SHOULDER CLOSURE, USE THE DETAIL FOR SHORT OR INTERMEDIATE TERM STATIONARY FLAGGING OPERATION.
2. NO WORK ACTIVITY OR STORAGE OF EQUIPMENT, VEHICLES, OR MATERIAL SHOULD OCCUR WITHIN A BUFFER SPACE.
3. FOR BARRIER VEHICLE USE REQUIREMENTS SEE TABLES NY1-A AND NY2-A ON THE STANDARD SHEET TITLED "WORK ZONE TRAFFIC CONTROL LEGENDS AND NOTES".
4. SIGNS SHALL CONFORM TO NYS DOT STANDARD SHEETS 619-12 TITLED "SIGN TABLE". (2 SHEETS)
5. NYS DOT STANDARD SHEETS 619-10, 619-11, 619-20, 619-50, 619-60, 619-63, 619-64 ARE SHOWN ON SHEET T106.
6. REFER TO WZTC SHEETS T101 THROUGH T105 FOR WORK ZONE TRAFFIC CONTROLS TYPICAL PLANS. CONTRACTOR SHALL USE THE APPROPRIATE CONTROLS CONFORMING TO NYS DOT STANDARDS FOR THE WORK ZONES NEEDING PROTECTION WHETHER OR NOT DETAILED HEREIN.

TRAFFIC CONTROL ON LAWRENCE STREET:

TRAFFIC CONTROL FOR WORK ZONE IN NORTH SIDE PARKING AND TRAVEL LANES - COMPLY WITH THE REQUIREMENTS OF NYS DOT STANDARD SHEET 619-63 FOR A SINGLE LAND SHIFT WITH SIGNS PLACED ON THE NORTH SIDE OF LAWRENCE STREET. CONE OFF PARKING SPACES AND POST TEMPORARY NO PARKING SIGNS AS NEEDED -- BOTH SIDES OF THE ROAD - IF PAVEMENT WIDTH IS LESS THAN 18 FEET.

SIDEWALK CLOSURE - IN ACCORDANCE WITH THE REQUIREMENTS OF NYS DOT STANDARD SHEET 619-50.

REFER TO SHEETS T101, T105 FOR WORK ZONE TRAFFIC CONTROLS ON LAWRENCE STREET INVOLVING OTHER LANE CLOSURE CONFIGURATIONS.

