

NOTE: ALL EXISTING DIMENSIONS AND ELEVATIONS INDICATED OR REPRESENTED BY THIS DRAWING ARE OWNED BY AND ARE THE PROPERTY OF KGD+D ARCHITECTS PC. CONTRACTOR SHALL VERIFY AND BE RESPONSIBLE FOR ALL DIMENSIONS AND CONDITIONS ON THE JOB AND THE OFFICE SHALL BE ADVISED OF ANY VARIATIONS FROM EXISTING AND CONDITIONS SHOWN BY THESE DRAWINGS. SHOP DETAILS MUST BE SUBMITTED TO THIS OFFICE FOR APPROVAL BEFORE PROCEEDING WITH FABRICATION.

LEGAL NOTICE: ALTERATIONS BY ANY PERSON IN ANY WAY OF ANY ITEM COMPRISED IN THIS DOCUMENT, UNLESS ACTING UNDER THE DIRECTION OF THE LICENSED ARCHITECT WHOSE PROFESSIONAL SEAL IS AFFIXED HERETO, IS A VIOLATION OF TITLE 18, SECTION 86.03 OF NEW YORK STATE LAW.

© Copyright KGD+D Architects, P.C. All rights reserved.

Professional Seal

No.	Date	Issue
4	11-01-2021	ISSUE FOR BID
3	07-14-21	CONST. DOCS - FOR NYSD
2	12-15-20	DESIGN DEVELOPMENT
1	08-31-20	SCHEMATIC DESIGN

**WORK ZONE TRAFFIC CONTROLS - 2**

Job No.	Date
2019-1026	06-24-21
Scale:	Drawn / Checked
AS NOTED	--
Sheet No.	

**LEGEND**

- P — EXISTING PROPERTY LINE
- EXISTING EDGE OF PAVEMENT
- EXISTING CURB
- X — X — EXISTING FENCE
- X — X — EXISTING SIGN
- 25 — EXISTING 5' CONTOUR
- 10 — EXISTING 1' CONTOUR
- 81.2 — EXISTING SPOT GRADE
- 4 — EXISTING UTILITY POLE WITH OVERHEAD WIRES
- O — EXISTING LIGHT POLES
- C — EXISTING UNDERGROUND COMMUNICATION LINE
- T — EXISTING UNDERGROUND TV LINE
- G — EXISTING UNDERGROUND GAS LINE
- W — EXISTING UNDERGROUND WATER LINE
- H — EXISTING WATER VALVE & HYDRANT
- V — EXISTING GAS VALVES
- D — EXISTING UNDERGROUND DRAINAGE LINE
- S — EXISTING DRAINAGE STRUCTURE
- 10 — PROPOSED 10' CONTOUR
- 1 — PROPOSED 1' CONTOUR
- 80.5 — PROPOSED SPOT ELEVATION

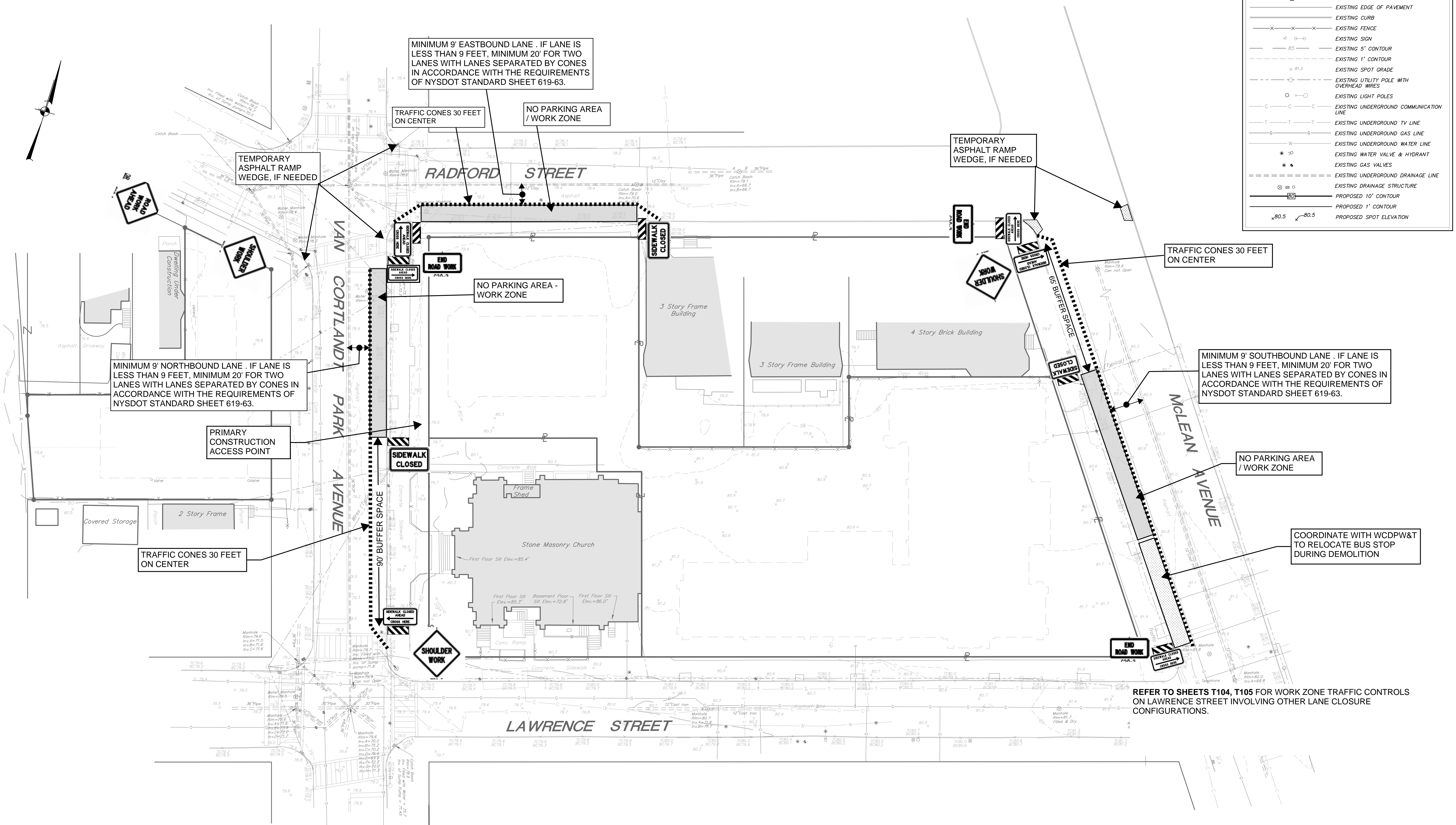

**TRAFFIC CONTROL ON EAST SIDE OF VAN CORTLANDT PARK AVE:**

**TRAFFIC CONTROL FOR WORK ZONE IN EAST SIDE PARKING LANE -** COMPLY WITH THE REQUIREMENTS OF NYSDOT STANDARD SHEET 619-20 WITH SIGNS PLACED ON THE EAST SIDE OF VAN CORTLANDT PARK AVENUE. CONE OFF PARKING SPACES AND POST TEMPORARY NO PARKING SIGNS AS NEEDED.

**SIDEWALK CLOSURE -** IN ACCORDANCE WITH THE REQUIREMENTS OF NYSDOT STANDARD SHEET 619-50.

**TRAFFIC CONTROL ON SOUTH SIDE OF RADFORD STREET:**

**TRAFFIC CONTROL FOR WORK ZONE IN SOUTH SIDE PARKING LANE -** COMPLY WITH THE REQUIREMENTS OF NYSDOT STANDARD SHEET 619-20 WITH SIGNS PLACED ON THE SOUTH SIDE OF RADFORD STREET. CONE OFF PARKING SPACES AND POST TEMPORARY NO PARKING SIGNS AS NEEDED.

**SIDEWALK CLOSURE -** IN ACCORDANCE WITH THE REQUIREMENTS OF NYSDOT STANDARD SHEET 619-50.

**REFER TO SHEETS T103, T104, T105 FOR WORK ZONE TRAFFIC CONTROLS ON RADFORD STREET INVOLVING OTHER LANE CLOSURE CONFIGURATIONS.**

**NOTES:**

- WHEN THE MINIMUM LANE WIDTH OF 10' CANNOT BE MAINTAINED DUE TO A SHOULDER CLOSURE, USE THE DETAIL FOR SHORT OR INTERMEDIATE TERM STATIONARY FLAGGING OPERATION.
- NO WORK ACTIVITY OR STORAGE OF EQUIPMENT, VEHICLES, OR MATERIAL SHOULD OCCUR WITHIN A BUFFER SPACE.
- FOR BARRIER VEHICLE USE REQUIREMENTS SEE TABLES NY1-A AND NY2-A ON THE STANDARD SHEET TITLED "WORK ZONE TRAFFIC CONTROL LEGENDS AND NOTES".
- SIGNS SHALL CONFORM TO NYSDOT STANDARD SHEETS 619-12 TITLED "SIGN TABLE". (2 SHEETS)
- NYSDOT STANDARD SHEETS 619-10, 619-11, 619-20, 619-50, 619-60, 619-63, 619-64 ARE SHOWN ON SHEET T106.
- REFER TO WZTC SHEETS T101 THROUGH T105 FOR WORK ZONE TRAFFIC CONTROLS TYPICAL PLANS. CONTRACTOR SHALL USE THE APPROPRIATE CONTROLS CONFORMING TO NYSDOT STANDARDS FOR THE WORK ZONES NEEDING PROTECTION WHETHER OR NOT DETAILED HEREIN.

**TRAFFIC CONTROL ON MCLEAN AVENUE:**

**TRAFFIC CONTROL FOR WORK ZONE IN WEST SIDE PARKING LANE -** COMPLY WITH THE REQUIREMENTS OF NYSDOT STANDARD SHEET 619-20 WITH SIGNS PLACED ON THE WEST SIDE OF MCLEAN AVENUE. CONE OFF PARKING SPACES AND POST TEMPORARY NO PARKING SIGNS AS NEEDED.

**SIDEWALK CLOSURE -** IN ACCORDANCE WITH THE REQUIREMENTS OF NYSDOT STANDARD SHEET 619-50.

**REFER TO SHEET T103 FOR WORK ZONE TRAFFIC CONTROLS ON MCLEAN AVENUE INVOLVING OTHER LANE CLOSURE CONFIGURATIONS.**

