

LEGEND

- EXISTING PROPERTY LINE
- EXISTING EDGE OF PAVEMENT
- EXISTING CURB
- EXISTING FENCE
- EXISTING SIGN
- EXISTING LANDSCAPING
- EXISTING HEDGE ROW
- PROPOSED FENCE
- PROPOSED # OF STALLS TO BE STRIPED
- PROPOSED 6" CONCRETE CURB
- PROPOSED 4" MOUNTABLE CONCRETE CURB
- PROPOSED RETAINING WALL
- PROPOSED PAINTED CROSSWALK
- PROPOSED CURB RAMP
- PROPOSED PAINTED HANDICAP PARKING SYMBOL
- PROPOSED STRIPED ISLAND
- PROPOSED SINGLE POLE SIGN
- PROPOSED DOOR LOCATION
- PROPOSED LANDSCAPING
- PROPOSED CONCRETE SURFACE
- PROPOSED CONCRETE SLAB WITH RUBBERIZED PLAY MATS
- PROPOSED POURED IN PLACE RUBBERIZED PLAY SURFACE OVER ASPHALT BASE
- PROPOSED POLE MOUNTED LIGHT
- PROPOSED SNOW STORAGE AREA

SIGN DATA TABLE

LOCATION NO.	TEXT	M.U.T.C.D. NUMBER	SIZE OF SIGN (s.f.)	DESCRIPTION
1		R7-8	12" x 18"	Blue on White
2		R7-1	12" x 18"	Red on White

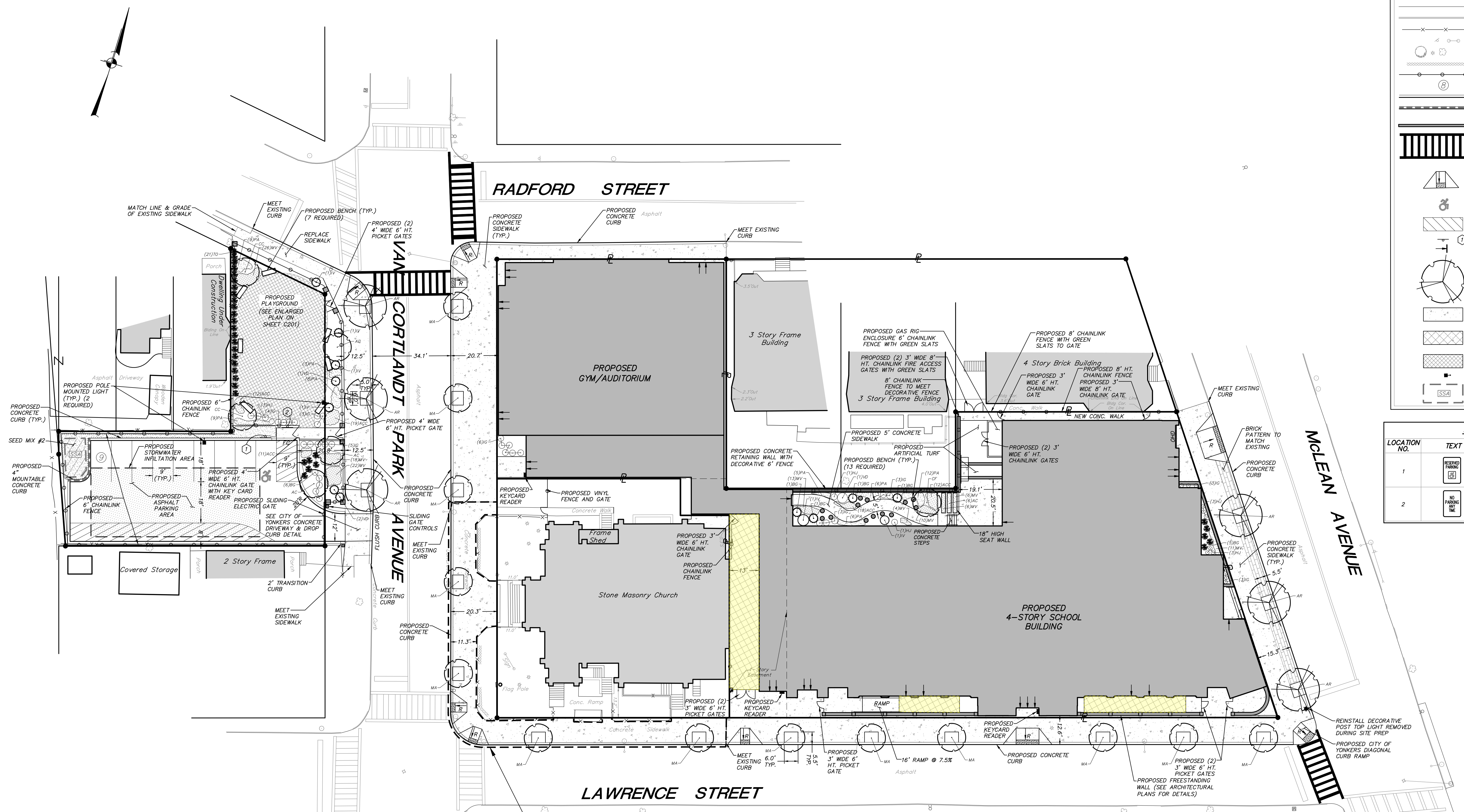

ADD/ALT SIDEWALK & CURB REPLACEMENT REFER TO SPEC SECTION 012300 CONCRETE CURB & SIDEWALK TO BE REMOVED AND REPLACED

PLANT LIST

SYMBOL	KEY	QUANTITY	BOTANICAL / COMMON NAME	SIZE	ROOT/SPACING
SHADE TREES					
AR	7		Acer rubrum / Red Maple	8'-10" HT.	8&8
MA	9		Malus 'Adirondack' / Adirondack Crabapple	8'-10" HT.	8&8
MA	4	ADD/ALT	Malus 'Adirondack' / Adirondack Crabapple	8'-10" HT.	8&8
TO	21		Thuja occidentalis 'Smaragd' / Smaragd Arborvitae	6'-7" HT.	8&8
FLOWERING TREES					
AC	3		Amelanchier canadensis / Serviceberry	8'-10" HT.	8&8
CC	2		Cercis canadensis / Redbud	8'-10" HT.	8&8
SHRUBS					
BD	15		Buxus 'Green Mountain' / Green Mountain Boxwood	#2 CONT.	36" O.C.
IC	35		Ilex glabra 'Shamrock' / Inkberry Holly	#2 CONT.	36" O.C.
IV	6		Itea virginica 'Henry's Garnet' / Henry's Garnet Sweetgum	#5 CONT.	72" O.C.
VD	4		Viburnum dentatum 'Blue Muffin' / Blue Muffin Viburnum	#3 CONT.	48" O.C.
PERENNIALS/GROUND COVERS					
ACC	84		Aquilegia canadensis / Columbine	#1 CONT.	18" O.C.
HJ	11		Hosta 'June' / June Hosta	#2 CONT.	30" O.C.
MV	116		Mertensia virginica / Virginia Bluebells	#1 CONT.	18" O.C.
PA	58		Polystichum acrostichoides / Christmas Fern	#1 CONT.	24" O.C.

GENERAL SITE SEEDING NOTES:

- All proposed seeded areas to receive 4" min. depth of topsoil. Soil amendments and fertilizer application rates shall be determined based on specific testing of topsoil material.
- Upon final grading and placement of topsoil and any required soil amendments, areas to receive permanent vegetation cover in combination with suitable mulch as follows:
 - select seed mixture per drawings and seeding notes.
 - fertilizer applied at the manufacturer's recommended rate using Lesco 10-0-18 (no phosphorus) fertilizer or equivalent.
 - mulch: soft hay or small grain straw applied at a rate of 90 lbs./1000 s.f. or 2 tons/acre, to be applied and anchored according to New York State Standards and Specifications for Erosion and Sediment Control, August 2005.
 - if the season prevents the establishment of a permanent vegetation cover, the disturbed areas will be mulched with straw or equivalent.
- The seed mixes as specified on these drawings are as follows:
 - Seed Mix #1 for lawn areas and mow strip along roads at a rate of 100 lbs. per acre:
 - Kentucky Bluegrass 20%
 - Creeping Red Fescue 40%
 - Perennial Ryegrass 20%
 - Annual Ryegrass 20%
 - Seed Mix #2 for around playground parking lot and snow storage area (SSA) as indicated in the plan at a rate of 1 lb. per 1,000 s.f.:
 - Dutch White Clover 50%
 - Annual Ryegrass 50%

GENERAL PLANTING NOTES:

- All proposed planting beds to receive a 12" min. depth of topsoil. Soil amendments and fertilizer application rates shall be determined based on specific testing of topsoil material.
- Any new soils added will be amended as required by results of soil testing and placed using a method that will not cause compaction.
- All plant material to be nursery grown.
- Plants shall conform with ANSI Z60.1 American Standard for Nursery Stock in all ways including dimensions.
- Plant material shall be taken from healthy nursery stock.
- All plants shall be grown under climate conditions similar to those in the locality of the project.
- Plants shall be planted in all locations designed on the plan or as staked in the field by the Landscape Architect.
- The location and layout of landscape plants shown on the site plan shall take precedence in any discrepancies between the quantities of plants shown on the plans and the quantity of plants in the Plant List.
- Provide a 3" layer of shredded pine bark mulch (or as specified) over entire watering saucer of all tree sites or over entire planting bed. Do not place mulch within 3" of tree or shrub trunks.
- All landscape plantings shall be maintained in a healthy condition at all times. Any dead or diseased plants shall immediately be replaced "in kind" by the contractor (during warranty period) or project owner.

NOTE: ALL DIMENSIONS, ARRANGEMENTS AND PLANS INDICATED OR REPRESENTED BY THIS DRAWING ARE OWNED BY AND ARE THE PROPERTY OF KGD+D ARCHITECTS, PC. ANY REUSE, REPRODUCTION, OR MODIFICATION OF THIS DRAWING WITHOUT THE WRITTEN PERMISSION OF KGD+D ARCHITECTS, PC IS STRICTLY PROHIBITED. ANY REUSE, REPRODUCTION, OR MODIFICATION OF THIS DRAWING WITHOUT THE WRITTEN PERMISSION OF KGD+D ARCHITECTS, PC IS STRICTLY PROHIBITED.



No.	Date	Issue
11/01/2021		ISSUE FOR BID
08/24/2021		NYSED ADDENDUM 1
07/14/2021		CONST. DOCS - FOR NYSED
12/15/2020		DESIGN DEVELOPMENT
08/31/2020		SCHEMATIC DESIGN

LAYOUT AND LANDSCAPE PLAN

Job No.	2018-1071	Date	8/30/2020
Scale:	1" = 20'	Drawn / Checked	MEU/AT

Sheet No. **C200**

