

NEW COMMUNITY SCHOOL 35 AT ST DENIS SITE

YONKERS JOINT SCHOOLS
CONSTRUCTION BOARD
121 McLean Avenue
Yonkers, NY 10705



NY SED PROJECT CONTROL NO.
66-23-00-01-0-346-001

CONSTRUCTION DOCUMENTS

GENERAL NOTES

- 1 [Symbol] DENOTES INSULATED CLEAR GLAZING
- 2 [Symbol] DENOTES INSULATED SPANDREL FRITTED GLAZING
- 3 [Symbol] DENOTES INSULATED CERAMIC FRITTED GLAZING
- 4 [Symbol] DENOTES INSULATED TRANSLUCENT GLAZING
- 5 GLAZING IN DOORS, SIDELIGHTS & WITHIN 18" OF GRADE, FLOORS, STAIR LANDINGS SHALL BE TEMPERED GLASS
- 6 ALL EXTERIOR LOUVERS SHALL BE 4" DEEP ALUM. HORIZONTAL BLADE, STORM-PROOF, DRAINABLE, w/ 50% FREE AREA (MIN) IN PREMIUM (KYNAR) METALLIC (OR CUSTOM) COLOR SELECTED BY ARCHITECT, w/ BIRD SCREEN (SIM TO RUSKIN ELF375DX)
- 7 G.C. SHALL PROVIDE LOUVERS & SHALL COORDINATE FREE AREA REQ'D w/ H.C.
- 8 H.C. CONTRACTOR SHALL BLANK-OFF w/ BLACK PTD SHEETMETAL & INSULATE ALL UNUSED PORTIONS OF LOUVERS
- 9 [Symbol] DENOTES DOOR NUMBER, SEE A902 & A903 FOR DOOR & HARDWARE INFO
- 10 [Symbol] DENOTES WINDOW TYPE, SEE A904 FOR SIZES & OTHER INFO
- 11 RW DENOTES RESCUE WINDOW, PROVIDE 24" MINIMUM "CLEAR" WIDTH & 5 SF MINIMUM "CLEAR" AREA - SEE SCREEN INFO BELOW
- 12 PROVIDE INSECT SCREENS FOR ALL OPERABLE WINDOWS. SCREENS FOR RESCUE WINDOWS SHALL BE HINGED & SHALL BE OPERABLE FROM THE INSIDE WITH ONE HAND & WITHOUT THE USE OF A KEY OR OTHER DEVICE

HOLLOW METAL FRAME

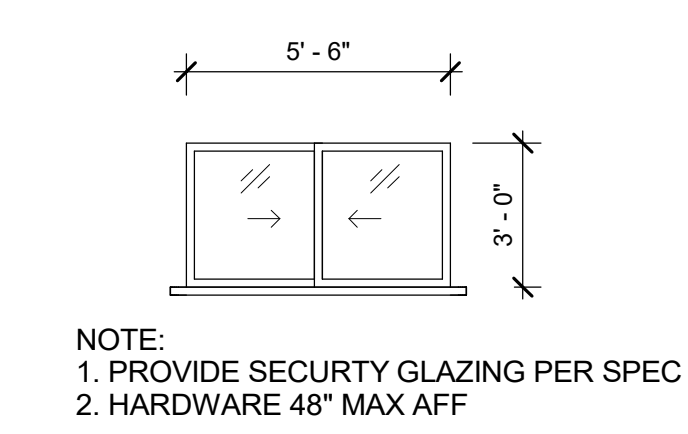

T1 TRANSACTION WINDOW
1/4" = 1'-0"

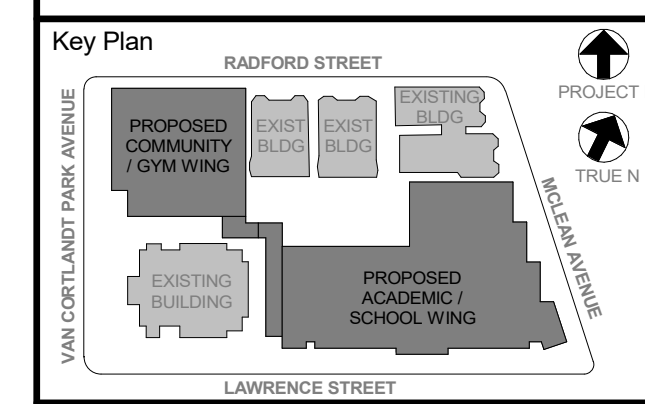
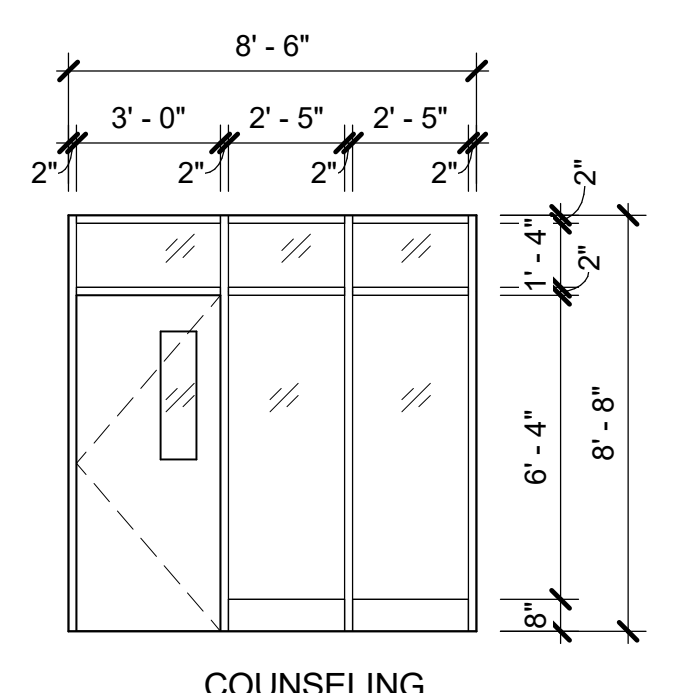
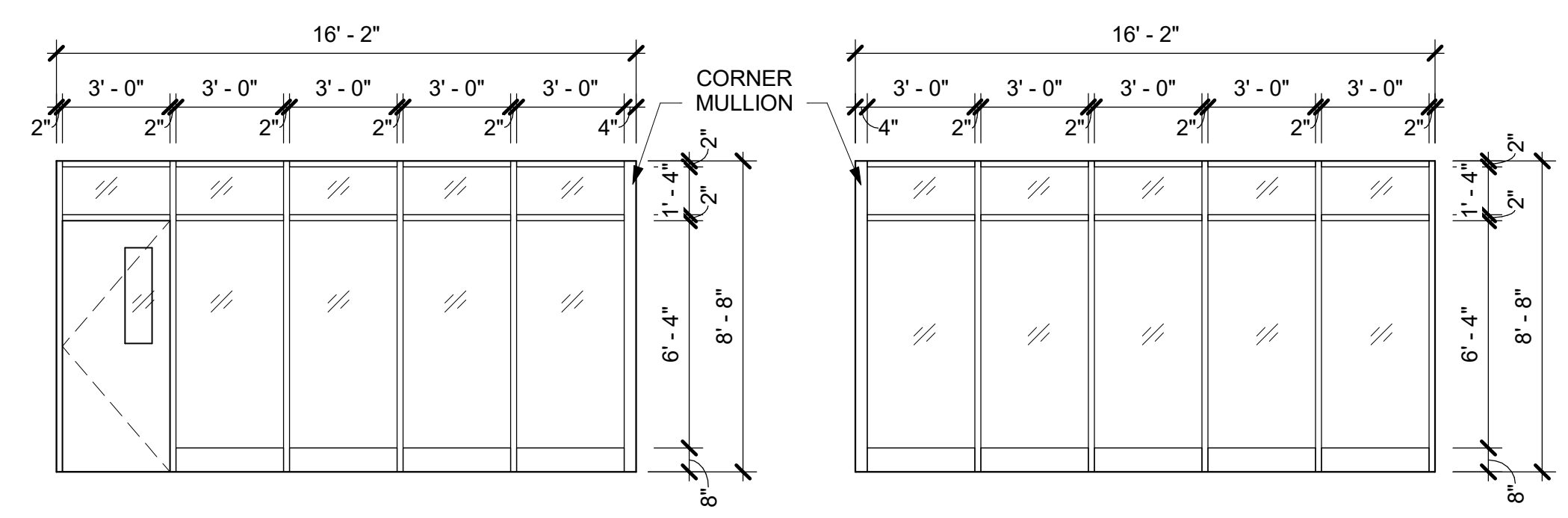

NOTE: ALL IDEAL DESIGN ARRANGEMENTS ARE PLANNED AND INDICATED OR REPRESENTED BY THIS DRAWING AND ARE THE PROPERTY OF THE ARCHITECT. ANY CHANGES TO THE IDEAL DESIGN ARRANGEMENTS OR FOR USE ON THIS PROJECT, NONE OF SUCH IDEAS, DESIGNS, ARRANGEMENTS OR PLANS SHALL BE USED BY ANY CONTRACTOR OR ANY OTHER PARTY WITHOUT THE WRITTEN PERMISSION OF THE ARCHITECT.

WRITTEN DIMENSIONS ON THIS DRAWING SHALL HAVE PRECEDENCE OVER UNLabeled DIMENSIONS. CONTRACTOR SHALL VERIFY ALL ACTUAL DIMENSIONS AND CONDITIONS ON THE JOB AND THE ARCHITECT MUST BE NOTIFIED OF ANY VARIATIONS FROM DIMENSIONS AND CONDITIONS SHOWN. ANY RETAIL MUST BE SUBMITTED TO THIS OFFICE FOR APPROVAL BEFORE PROCEEDING WITH FABRICATION.

ALTERATIONS BY ANY PERSON, IN ANY WAY, OF ANY ITEM CONTAINED ON THIS DOCUMENT, UNLESS ACTING UNDER THE DIRECTION OF THE LICENSED ARCHITECT, ENGINEER, PROFESSIONAL DESIGNER OR ARCHITECT, IS A VIOLATION OF COPYRIGHT AND TRADE SECRET LAWS AND IS PROHIBITED BY LAW.

KG+D ARCHITECTS, PC
285 MAIN STREET - MOUNT KISCO, NEW YORK 10549
P:914.666.5900 KGDARCHITECTS.COM

Professional Seal

No.	Date	Issue
5	11/01/2021	ISSUE FOR BID
3	07/14/2021	CONSTRUCTION DOCS - NYS ED
2	12/15/2020	DESIGN DEVELOPMENT

Sheet Title	
HOLLOW METAL WINDOW & DOOR ASSEMBLIES	
Job No.	Date
2019-1026	12/15/2020
Scale	Drawn / Checked
AS NOTED	--
Sheet Number	
A905	

