

**NEW COMMUNITY SCHOOL 35 AT ST DENIS SITE**

YONKERS JOINT SCHOOLS  
CONSTRUCTION BOARD  
121 McLean Avenue  
Yonkers, NY 10705



NY SED PROJECT CONTROL NO.  
**66-23-00-01-0-346-001**

**CONSTRUCTION DOCUMENTS**

**GENERAL NOTES**

- 1 (A) DENOTES WINDOW TYPE, SEE DWG A904 & A905
- 2 (D) DENOTES DOOR NUMBER, SEE DOOR SCHEDULE ON A902
- 3 C J CONTROL JOINT
- 4 RW DENOTES RESCUE WINDOW SEE A904 & SPECS FOR MORE INFO
- 5 ALL EXTERIOR LOUVERS SHALL BE 4" DEEP, ALUM. HORIZ BLADE, STORMPROOF, DRAINABLE w/50% FREE AREA (MIN) FINISHED IN PREM. (KYNAR) METALLIC COLOR AS SELECTED BY ARCHITECT w/BIRD SCREEN, (SIM OR EQUAL TO RUSKIN ELF3750X)
- 6 G.C. SHALL PROVIDE LOUVERS & COORDINATE FREE AREA REQUIREMENTS w/MECHANICAL CONTRACTOR
- 6 GLAZING IN DOORS, SIDELIGHTS & WITHIN 18" OF GRADE, FLOORS, & STAIR LANDINGS SHALL BE TEMPERED GLASS. SEE SPECS FOR MORE INFO

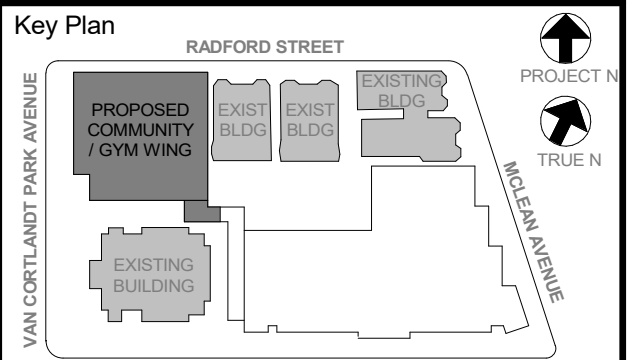

NOTE: ALL LOCAL DESIGN REQUIREMENTS AND PLANS INDICATED OR REPRESENTED BY THIS DRAWING ARE OWNED BY AND ARE THE PROPERTY OF YONKERS JOINT SCHOOLS ARCHITECTS, PC (YJAS) AND HAVE BEEN CREATED FOR USE ON THIS PROJECT. NONE OF SUCH LOCAL DESIGN ARRANGEMENTS OR PLANS SHALL BE USED OR DISCLOSED TO ANY PURPOSE WHATSOEVER WITHOUT THE WRITTEN PERMISSION OF YJAS.

WRITTEN DIMENSIONS ON THIS DRAWING SHALL HAVE PRECEDENCE OVER SCALED DIMENSIONS. CONTRACTOR SHALL VERIFY ALL ACTUAL DIMENSIONS AND CONDITIONS ON THE JOB AND THE ARCHITECT MUST BE NOTIFIED OF ANY VARIATIONS FROM DIMENSIONS AND CONDITIONS SHOWN. SHOP DETAILS MUST BE SUBMITTED TO THIS OFFICE FOR APPROVAL BEFORE PROCEEDING WITH FABRICATION.

ALTERATIONS BY ANY PERSON IN ANY WAY OF ANY ITEM CONTAINED ON THIS DOCUMENT, UNLESS ACTING UNDER THE DIRECTION OF THE LICENSED ARCHITECT, ENGINEER, PROFESSIONAL DESIGNER, OR ARCHITECT, SHALL BE A VIOLATION OF PROFESSIONAL ETHICS AND SHALL BE SUBJECT TO PENALTY UNDER NEW YORK STATE LAW.

DATE: 08/31/2020  
PROJECT: NEW COMMUNITY SCHOOL 35 AT ST DENIS SITE  
DRAWN BY: J. GARDNER  
CHECKED BY: J. GARDNER  
SCALE: AS NOTED

Professional Seal

No.	Date	Issue
5	11/01/2021	ISSUE FOR BID
3	07/14/2021	CONSTRUCTION DOCS - NYSED
2	12/15/2020	DESIGN DEVELOPMENT
1	08/31/2020	SCHEMATIC DESIGN

**COMMUNITY WING BUILDING ELEVATIONS**

Job No. 2019-1026 Date 08/31/2020  
Scale AS NOTED Drawn / Checked - / -  
Sheet Number

**A311**

