

**NEW COMMUNITY SCHOOL 35 AT ST DENIS SITE**

YONKERS JOINT SCHOOLS  
CONSTRUCTION BOARD  
121 McLean Avenue  
Yonkers, NY 10705



NY SED PROJECT CONTROL NO.  
**66-23-00-01-0-346-001**

CONSTRUCTION DOCUMENTS

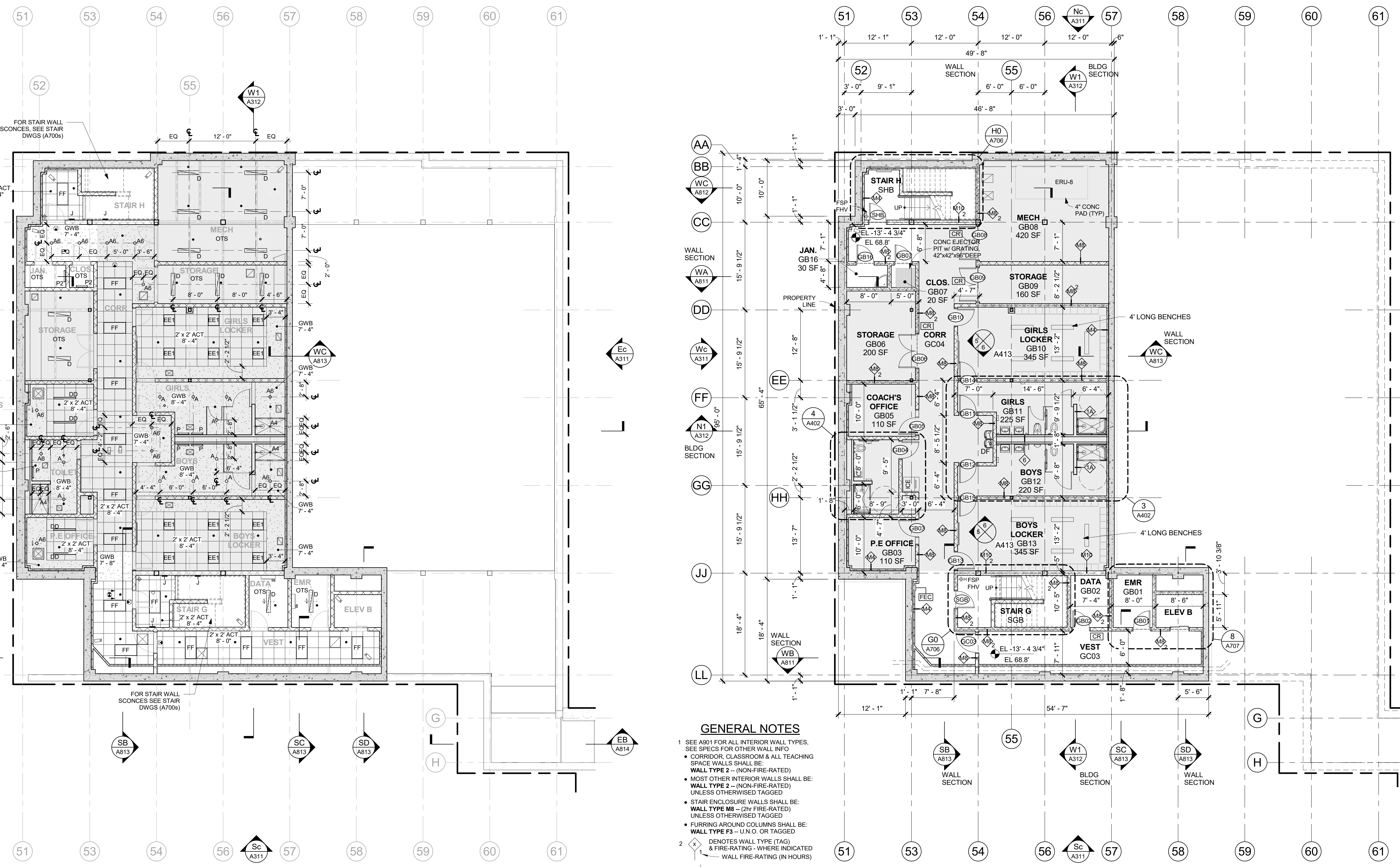

**CLNG GENERAL NOTES**

- 1 CEILING GRIDS SHALL BE CENTERED WITHIN THE ROOM OR SPACE
- 2 CEILING MOUNTED ELEMENTS (I.E. LIGHT FIXTURES, EXIT SIGNS, HVAC REGISTERS, SPRINKLER HEADS, SPEAKERS, WIRELESS ACCESS POINTS, ETC) SHALL BE CENTERED IN CEILING TILES
- 3 SEE E601 FOR LIGHT FIXTURE SCHEDULE
- 4 CEILING HEIGHTS SHOWN IN PLANS, SECTIONS, & DETAILS SHALL TAKE PRECEDENCE OVER HEIGHTS INDICATED ON SCHEDULES
- 5 EXACT LOCATION & ELEVATION OF CEILING MOUNTED ELEMENTS IN SUPPORT SPACES (I.E. MECHANICAL, ELECTRIC, DATA ROOMS, ETC) SHALL BE COORDINATED WITH ARCHITECT & RESPECTIVE CONTRACTORS/OWNER
- 6 LIGHT FIXTURE CENTERED IN ROOM/CEILING COORDINATE W/ EC LIGHT FIXTURE TAG
- 7 SEE MEP DRAWINGS FOR:
  - CEILING SUPPLY REGISTER
  - CEILING RETURN REGISTER
  - WALL MOUNTED SUPPLY REGISTER
  - WALL MOUNTED RETURN REGISTER
  - VRF DUCTLESS HEAT RECOVERY INDOOR UNIT
  - INDOOR DUCTLESS AIR HANDLING UNIT
  - CABINET HEATER
  - SPRINKLER HEAD
  - SECURITY CAMERA (BY OWNER, NIC)
  - CEILING /WALL MOUNTED EXIT SIGN

**2 COMMUNITY WING - BASEMENT ADD ALTERNATE CEILING PLAN**  
1/8" = 1'-0"

**GENERAL NOTES**

- 1 SEE A901 FOR ALL INTERIOR WALL TYPES. SEE SPECS FOR OTHER WALL INFO
  - CORRIDOR, CLASSROOM & ALL TEACHING SPACE WALLS SHALL BE: **WALL TYPE 2 - (NON-FIRE-RATED)**
  - MOST OTHER INTERIOR WALLS SHALL BE: **WALL TYPE 2 - (NON-FIRE-RATED)** UNLESS OTHERWISE TAGGED
  - STAIR ENCLOSURE WALLS SHALL BE: **WALL TYPE M8 - (2hr FIRE-RATED)** UNLESS OTHERWISE TAGGED
  - FURRING AROUND COLUMNS SHALL BE: **WALL TYPE F3 - U.N.O. OR TAGGED**
- 2 DENOTES WALL TYPE (TAG) & FIRE-RATING - WHERE INDICATED - WALL FIRE-RATING (IN HOURS)
- 3 DENOTES 2hr FIRE-RATED WALL TYPE
- 4 DENOTES NON-FIRE-RATED OR 1hr FIRE-RATED WALL TYPE
- 5 DENOTES DOOR NUMBER SEE A902 FOR DOOR SCHEDULE SEE A903 FOR OTHER DOOR INFO SEE SPEC FOR HARDWARE SETS
- 6 DENOTES HOLLOW METAL FRAME - SEE A904, A905 & SPECS FOR MORE INFO
- 7 RW DENOTES "RESCUE WINDOW" SEE SPECS FOR MORE INFO SEE A904 FOR WINDOWS
- 8 DIMENSIONS SHOWN FOR INTERIOR WALLS ARE EITHER: "FACE OF SHEETROCK" OR "FACE OF CMU"
- 9 FACE OF ADJACENT WALL TO EDGE OF DOOR FRAME IS 4" (TYP) U.N.O. (SEE DETAILS A, B & C ON A903)
- 10 MASONRY WALLS - ALL EXPOSED EDGES & ALL WALL OUTSIDE CORNERS SHALL BE BULLNOSE (E.G. C/A903)
- 11 SEE A508 & A507 FOR FINISH SCHEDULES
- 12 HATCH INDICATES ADD ALTERNATE CASEWORK, MILLWORK & GYM EQ.

**1 COMMUNITY WING - BASEMENT ADD ALTERNATE PLAN**  
1/8" = 1'-0"

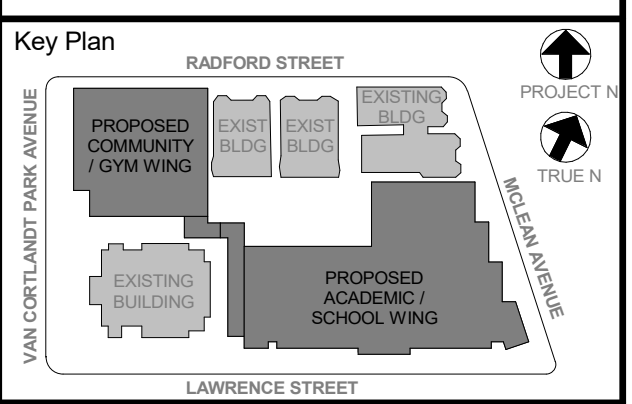

NOTE: ALL SCALE, SECTION, ARRANGEMENTS AND PLANS INDICATED OR REPRESENTED BY THIS DRAWING ARE OWNED BY AND ARE THE PROPERTY OF KG+D ARCHITECTS, PC. NO PART OF THIS DRAWING IS TO BE REPRODUCED OR TRANSMITTED IN ANY FORM OR BY ANY MEANS, ELECTRONIC OR MECHANICAL, INCLUDING PHOTOCOPYING, RECORDING, OR BY ANY INFORMATION STORAGE AND RETRIEVAL SYSTEM, WITHOUT THE WRITTEN PERMISSION OF KG+D.

WRITTEN DIMENSIONS ON THIS DRAWING SHALL TAKE PRECEDENCE OVER UNLESS OTHERWISE INDICATED. CONTRACTOR SHALL VERIFY ALL ACTUAL DIMENSIONS AND CONDITIONS ON THE JOB AND THE ARCHITECT MUST BE NOTIFIED OF ANY DISCREPANCIES FROM DIMENSIONS AND CONDITIONS SHOWN. ANY DETAILS MUST BE SUBMITTED TO THIS OFFICE FOR APPROVAL BEFORE PROCEEDING WITH FABRICATION.

ALTERATIONS BY ANY PERSON IN ANY WAY OF ANY ITEM CONTAINED ON THIS DOCUMENT, UNLESS ACTING UNDER THE DIRECTION OF THE LICENSED ARCHITECT, ENGINEER, PROFESSIONAL DESIGNER OR ARCHITECT, SHALL BE A VIOLATION OF COPYRIGHT AND FEDERAL, STATE AND LOCAL LAWS. KG+D ARCHITECTS, PC IS NOT RESPONSIBLE FOR SUCH VIOLATIONS.

Professional Seal

5 11/01/2021 ISSUE FOR BID  
No. Date Issue

**ADD ALTERNATE GYM BASEMENT FIT-OUT PLAN & RCP**

Job No. 2019-1026 Date 11/01/2021  
Scale AS NOTED Drawn / Checked -

Sheet Number  
**A213**

