

**NEW COMMUNITY SCHOOL 35 AT ST DENIS SITE**

YONKERS JOINT SCHOOLS CONSTRUCTION BOARD  
121 McLean Avenue  
Yonkers, NY 10705



NY SED PROJECT CONTROL NO.  
**66-23-00-01-0-346-001**

**CONSTRUCTION DOCUMENTS**

**GENERAL NOTES**

- SEE A801 FOR ALL INTERIOR WALL TYPES. SEE SPECS FOR OTHER WALL INFO
- MOST OTHER INTERIOR WALLS SHALL BE:
  - WALL TYPE 2 - (NON-FIRE-RATED)
  - WALL TYPE M8 - (2hr FIRE-RATED)
  - WALL TYPE 2 - (NON-FIRE-RATED) UNLESS OTHERWISE TAGGED
  - STAIR ENCLOSURE WALLS SHALL BE: WALL TYPE M8 - (2hr FIRE-RATED) UNLESS OTHERWISE TAGGED
  - FURRING AROUND COLUMNS SHALL BE: WALL TYPE F3 - U.N.O. OR TAGGED
- 1 DENOTES WALL TYPE (TAG) & FIRE-RATING - WHERE INDICATED - WALL FIRE-RATING (IN HOURS)
- 2 DENOTES 2hr FIRE-RATED WALL TYPE
- 2 DENOTES TYPE 2 WALL FIRE-RATED FOR 2 HOURS
- 1 DENOTES NON-FIRE-RATED OR 1hr FIRE-RATED WALL TYPE
- 1 DENOTES TYPE 1 WALL NON-FIRE-RATED
- 101 DENOTES DOOR NUMBER. SEE A802 FOR DOOR SCHEDULE. SEE A803 FOR OTHER DOOR INFO. SEE SPEC FOR HARDWARE SETS
- X DENOTES HOLLOW METAL FRAME - SEE A804, A805 & SPECS FOR MORE INFO
- RW DENOTES "RESCUE WINDOW" SEE SPECS FOR MORE INFO. SEE A804 FOR WINDOWS
- DIMENSIONS SHOWN FOR INTERIOR WALLS ARE EITHER "FACE OF SHEETROCK" OR "FACE OF CMU"
- FACE OF ADJACENT WALL TO EDGE OF DOOR FRAME IS 4" (TYP) U.N.O. (SEE DETAILS A, B & C ON A803)
- MASONRY WALLS - ALL EXPOSED EDGES & ALL WALL OUTSIDE CORNERS SHALL BE BULLNOSE (e.g. C/A803)
- SEE A806 & A807 FOR FINISH SCHEDULES
- HATCH INDICATES ADD ALTERNATE CASEWORK, MILLWORK & GYM EQ.

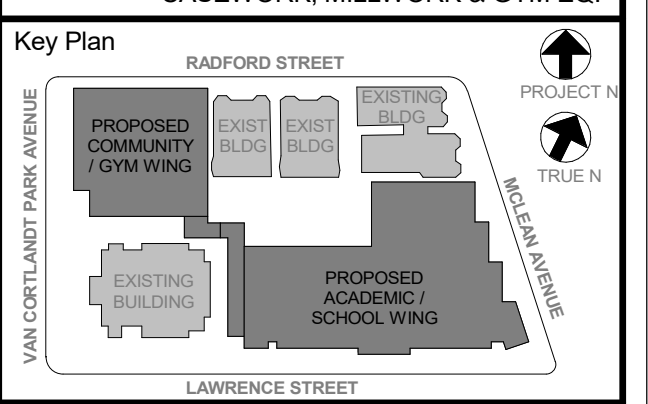

NOTE: ALL LOCAL ORDINANCES, REGULATIONS AND DEPARTMENTS NOTED OR REPRESENTED BY THIS DRAWING ARE OWNED BY AND ARE THE PROPERTY OF THE CLIENT. THE ARCHITECT HAS REVIEWED THE LOCAL ORDINANCES AND REGULATIONS FOR USE ON THIS PROJECT. NONE OF SUCH LOCAL ORDINANCES, REGULATIONS OR DEPARTMENTS SHALL BE USED BY OR DECIDED TO ANY PURPOSE WHATSOEVER WITHOUT THE WRITTEN PERMISSION OF KG+D.

WRITTEN DIMENSIONS ON THIS DRAWING SHALL HAVE PRECEDENCE OVER DIMENSIONS CONTRACTOR SHALL VERIFY ALL ACTUAL DIMENSIONS AND CONDITIONS ON THE JOB AND THE ARCHITECT MUST BE NOTIFIED OF ANY DISCREPANCIES FROM DIMENSIONS AND CONDITIONS SHOWN. SHOP DETAILS MUST BE SUBMITTED TO THIS OFFICE FOR APPROVAL BEFORE PROCEEDING WITH FABRICATION.

ALTERATIONS BY ANY PERSON, IN ANY WAY, OF ANY ITEM CONTAINED ON THIS DOCUMENT, UNLESS ACTING UNDER THE DIRECTION OF THE LICENSED ARCHITECT, IS UNAUTHORIZED. ANY SUCH ALTERATIONS SHALL BE A VIOLATION OF PROFESSIONAL ETHICS AND THE ARCHITECT'S LIABILITY INSURANCE COVERAGE WILL BE VOIDED. ANY SUCH ALTERATIONS SHALL BE THE RESPONSIBILITY OF THE PERSON MAKING SUCH ALTERATIONS.

Professional Seal

No.	Date	Issue
5	11/01/2021	ISSUE FOR BID
3	07/14/2021	CONSTRUCTION DOCS - NYSED
2	12/15/2020	DESIGN DEVELOPMENT
1	08/31/2020	SCHEMATIC DESIGN

Job No.	Date
2019-1026	08/31/2020
Scale	Drawn / Checked
AS NOTED	--
Sheet Number	<b>A200</b>

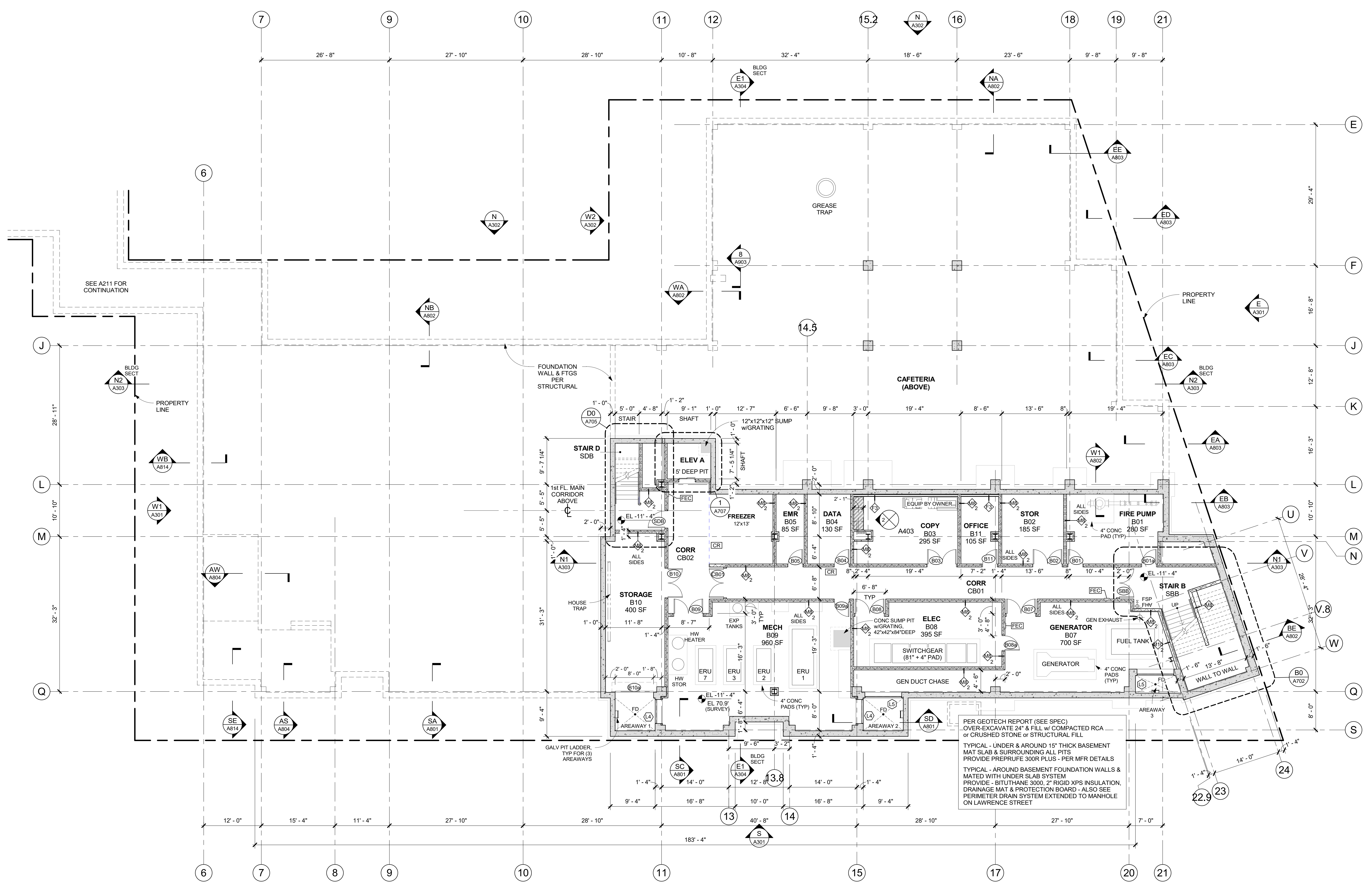

**B BASEMENT PLAN**  
1/8" = 1'-0"

