

BULLETIN # 3 6

DATE: May 12, 2026

TO: Piazza Inc.
Attn: John Piazza

CC: Chaker Maghak, Hill Intl.

FROM: Brian Dunn, AIA
KG+D Architects, PC

PROJECT: Harrison Recreation & Community Center – PHASE 2
Harrison, NY

RE: Site Plan Revisions



See attached ASK-39 for revisions to the Site Plan. The wood stockade fence and gates are deleted. The dumpster enclosure is deleted. The railing at the top of the modular block wall at the north side of the parking lot is deleted. Bollards are added in front of the building at the exterior side of Stair A. Add striping in front of the dumpster pad. Relocate pad to corner and re-size the concrete dumpster pad to be 15' x 10'. Remove and relocate the curbing at the transformer to be 8' from the centerline of the first EV charger including the radiused portion. Provide alternate pricing to extend the curbing into the NW corner of the parking lot, along the west side of the lot and at the islands on either side of the entry.

Encl: ASK-39

KG+D Architects, PC

285 Main Street, Mount Kisco, New York 10549
914.666.5900 kgdarchitects.com

**HARRISON
RECREATION &
COMMUNITY
CENTER**

New Construction - Phase 2

Town / Village of Harrison

270 Harrison Avenue
Harrison, NY 10528

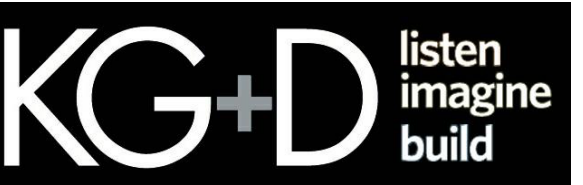

285 MAIN STREET • MOUNT KISCO, NEW YORK 10549
P:914.666.5900 KGDARCHITECTS.COM

CONSTRUCTION DOCUMENTS

NOTE: ALL IDEAS, DESIGN ARRANGEMENTS AND PLANS INDICATED OR REPRESENTED BY THIS DRAWING ARE OWNED BY AND ARE THE PROPERTY OF KG+D ARCHITECTS, PC AND ARE NOT TO BE REPRODUCED OR USED IN ANY PROJECT, NONE OF SUCH IDEAS, DESIGN ARRANGEMENTS OR PLANS SHALL BE USED BY OR DISCLOSED TO ANY THIRD PARTY WITHOUT THE WRITTEN PERMISSION OF KG+D ARCHITECTS, PC.

ALL DIMENSIONS ON THIS DRAWING SHALL HAVE PRECEDENCE OVER SCALES UNLESS OTHERWISE SPECIFIED. ALL ACTUAL DIMENSIONS AND CONDITIONS ON THE JOB AND THE ARCHITECT MUST BE NOTIFIED OF ANY VARIATIONS FROM DIMENSIONS AND CONDITIONS SHOWN ON THIS DRAWING. ALL RIGHTS RESERVED.

ALTERATIONS BY ANY PERSON IN ANY WAY OF ANY ITEM CONTAINED ON THIS DOCUMENT, UNLESS ACTING UNDER THE DIRECTION OF THE LICENSED ARCHITECT, ENGINEER, PROFESSIONAL DESIGNER OR ARCHITECT, IS A VIOLATION OF TITLE 16, SECTION 49-B OF THE NEW YORK STATE LAW.

ALL RIGHTS RESERVED.

Professional Seal

No.	Date	Issue
7	10/09/2024	CONFORMED SET
4	06/05/2024	ISSUED FOR BID
3	01/16/2024	ISSUED FOR PERMIT
2	06/01/2020	DESIGN DEVELOPMENT
1	03/31/2020	50% DESIGN DEVELOPMENT

Sheet Title

**ARCHITECTURAL
SITE PLAN**

Job No. 2020-1005 Date 03/31/2020

Scale AS NOTED Drawn / Checked

Sheet Number

ASK-39

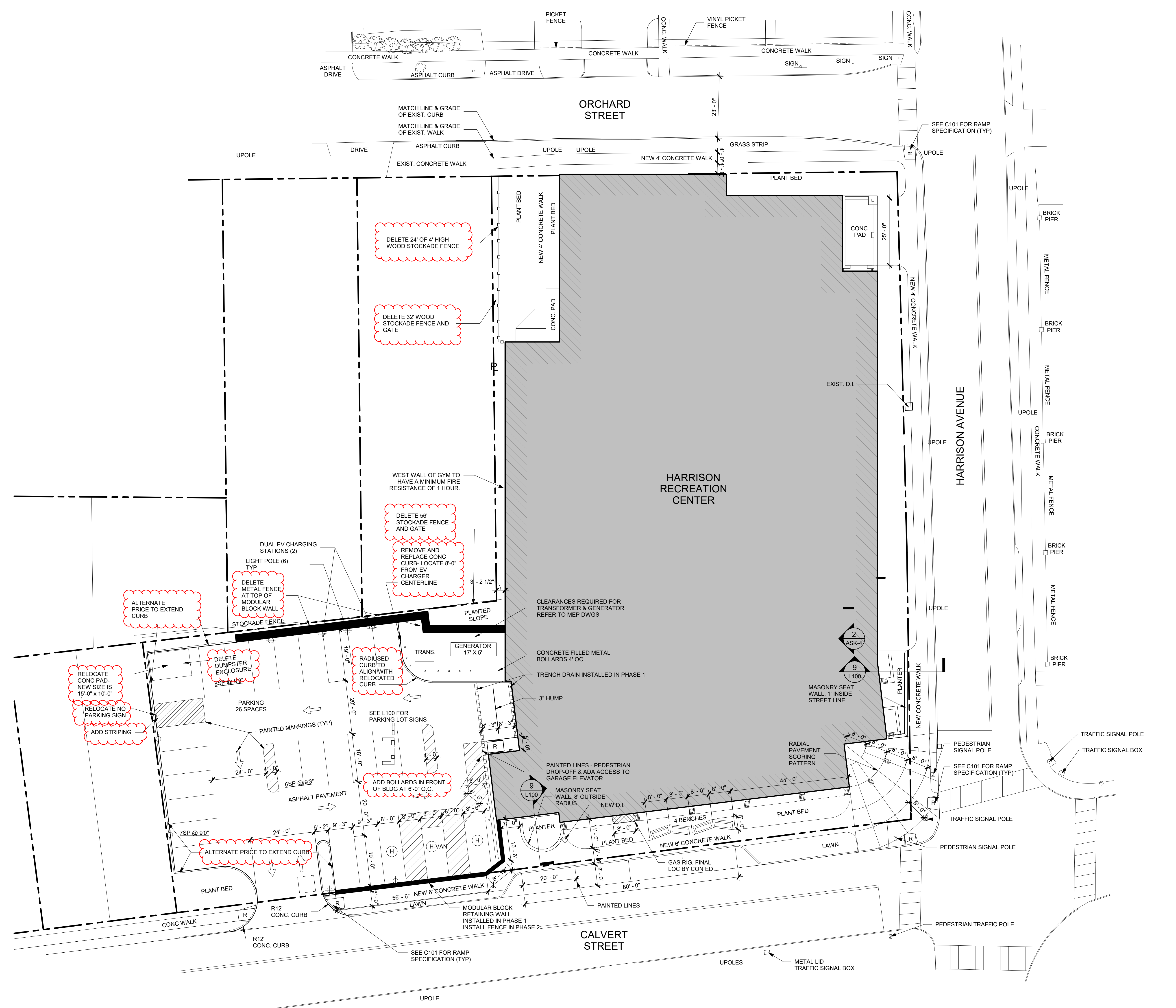

1 ARCHITECTURAL SITE PLAN

1/16" = 1'-0"

