

### 11 BORROWED LITE JAMB DETAIL

SCALE: 1 1/2" = 1'-0"

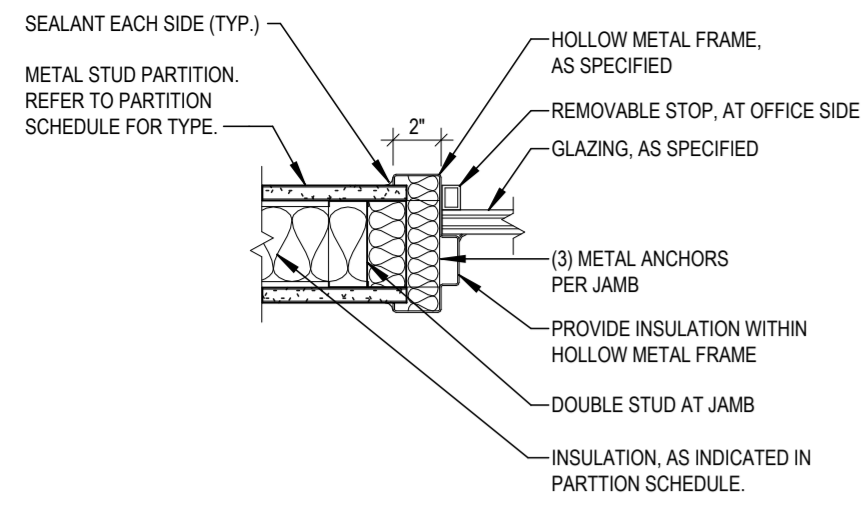

- WINDOW & LOUVER SCHEDULE NOTES:**
- VERIFY EXISTING ROUGH OPENING DIMENSIONS AND INSTALLATION REQUIREMENTS PRIOR TO FABRICATION.
  - PROVIDE WINDOW SHADE ASSEMBLY AS SPECIFIED.
  - PROVIDE SUB-FRAMING EXTENSIONS AS REQUIRED FOR ROUGH OPENING INSTALLATION.
  - WINDOW AND LOUVER TYPES LEGEND DEPICTS DESIGN INTENT. INSTANCES WHERE OPPOSITE AND MIRRORRED CONDITIONS OCCUR, VERIFY FINAL QUANTITY, SIZE, LOCATION, AND TYPE OF WINDOW AND LOUVER ASSEMBLIES IN FIELD.
  - LOUVER TYPE SIZES:
    - TYPE 1: 45" W x 47" H
    - TYPE 2: 39" W x 47" H
  - CONFIRM FINAL LOUVER SIZES WITH M-CONTRACTOR. BLANK OFF PERIMETER OF LOUVER AROUND DUCT SLEEVE AS REQUIRED FOR WEATHERTIGHT CONDITION.

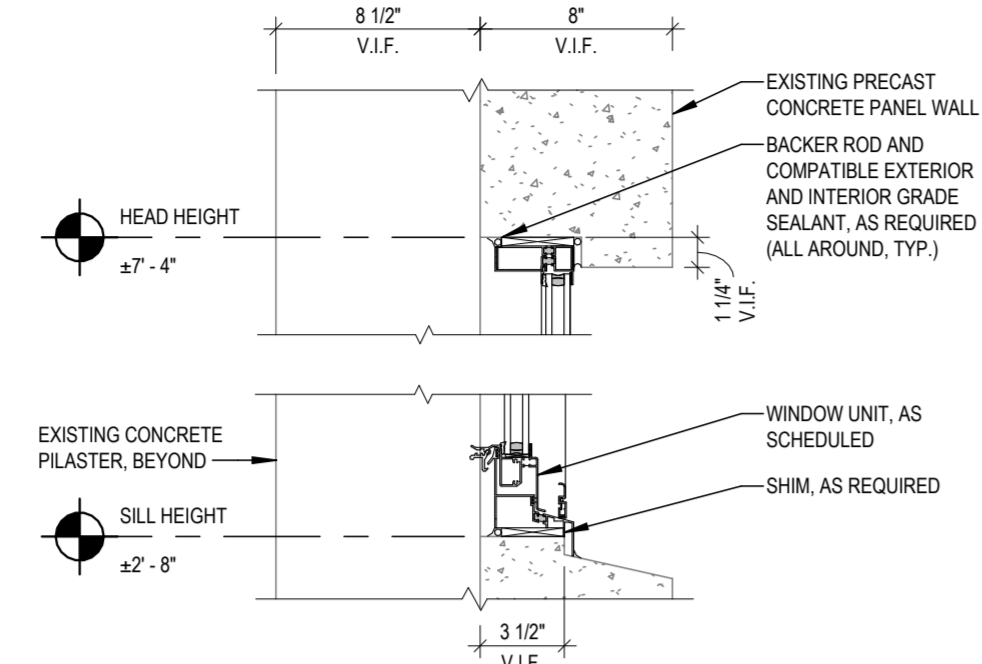

### 7 WINDOW HEAD/SILL DETAIL

SCALE: 1 1/2" = 1'-0"

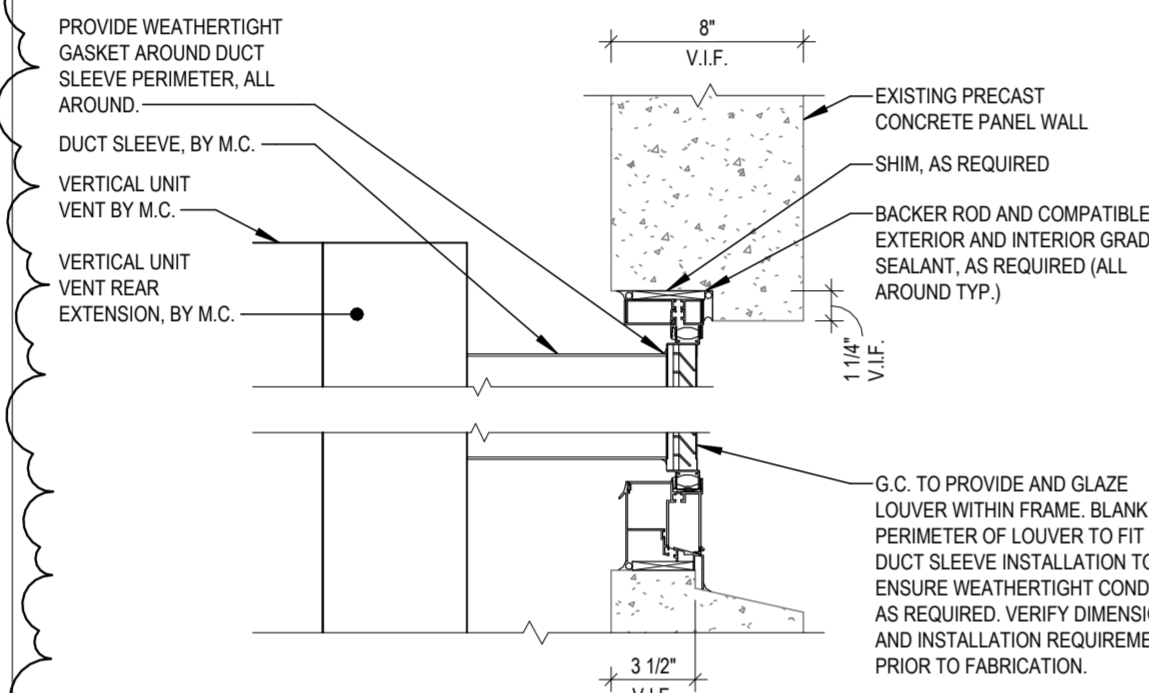

### 8 LOUVER HEAD/SILL DETAIL

SCALE: 1 1/2" = 1'-0"

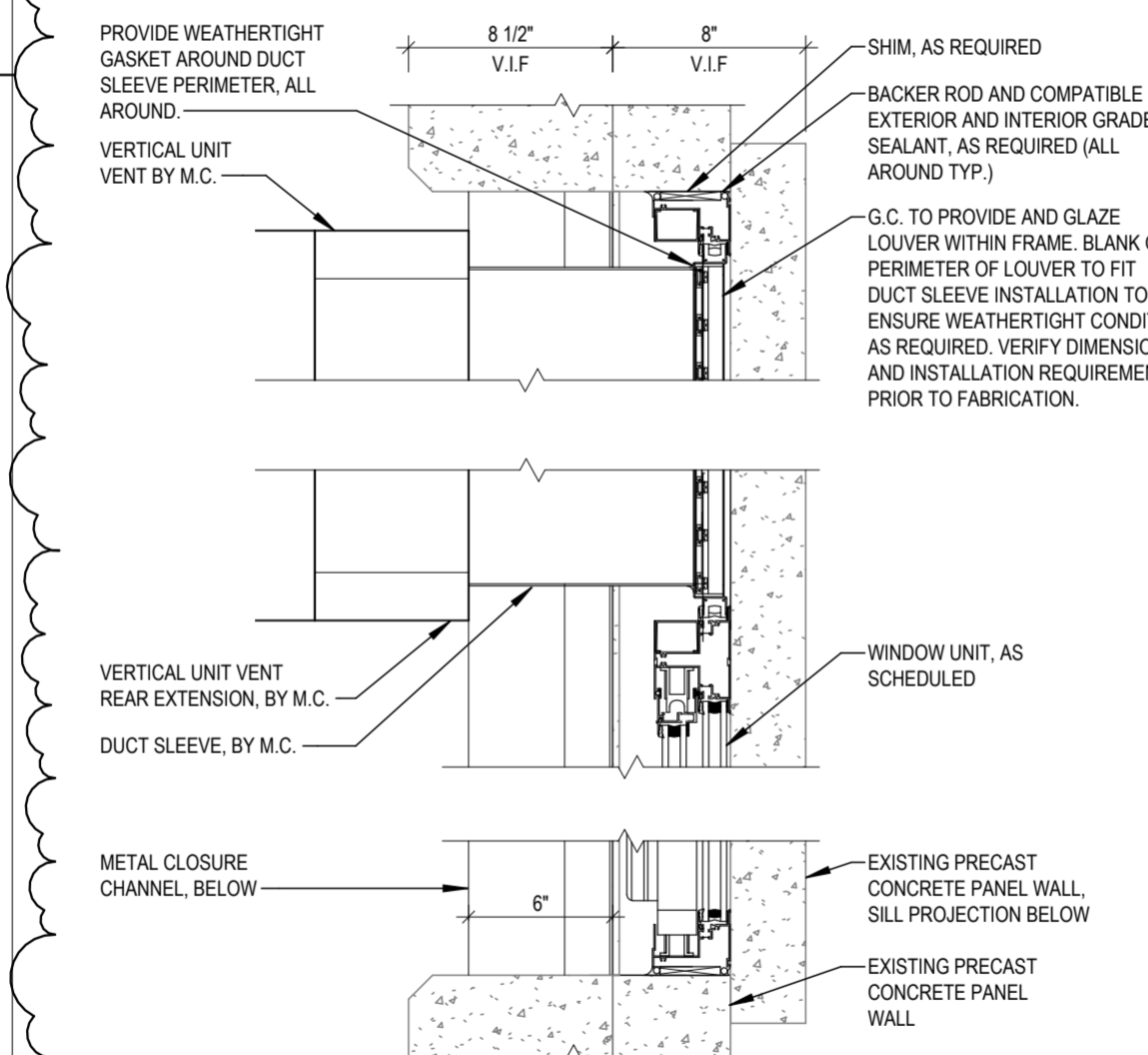

### 9 WINDOW - LOUVER JAMB DETAIL

SCALE: 1 1/2" = 1'-0"

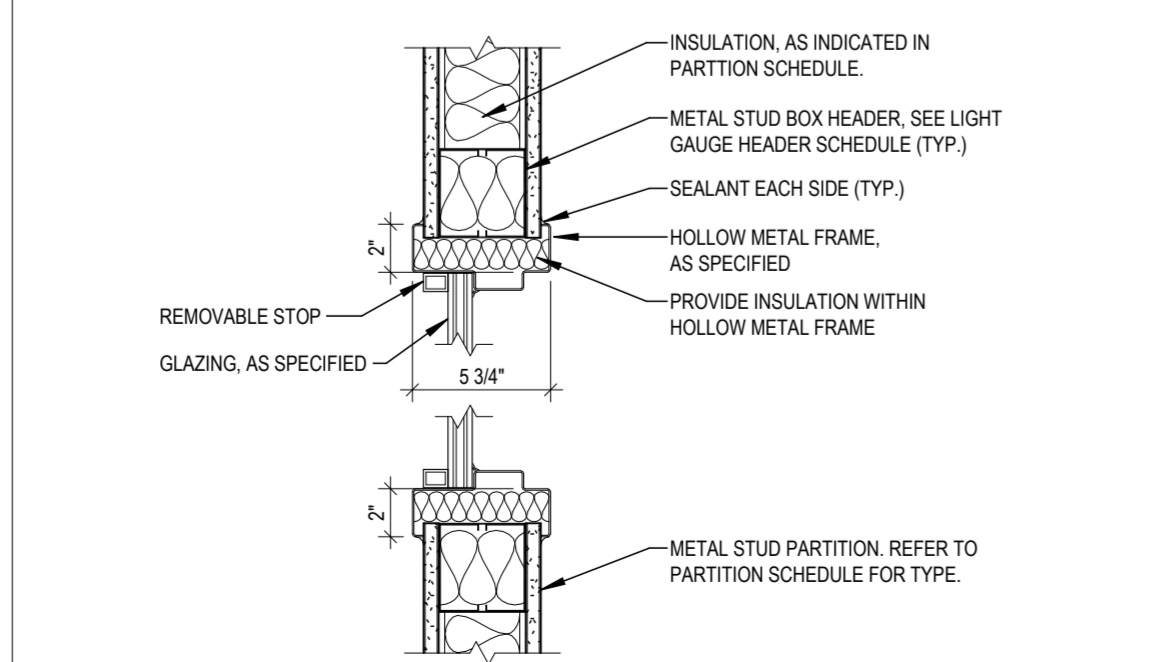

### 10 BORROWED LITE HEAD/SILL DETAIL

SCALE: 1 1/2" = 1'-0"

ROOM NO.	ROOM NAME	WINDOW TYPE (W)	LOUVER TYPE (L)	WIDTH	HEIGHT	SILL HEIGHT	GLAZING	REMARKS
107	MATH CLASSROOM	C	2	2'-6 1/2"	4'-8"	2'-8"	TYPE D	NOTE 5
108	MATH CLASSROOM	A	2	2'-6 1/2"	4'-8"	2'-8"	TYPE D	NOTE 5
109	MATH CLASSROOM	C	2	2'-6 1/2"	4'-8"	2'-8"	TYPE D	NOTE 5
111	BAND ROOM	B	-	7'-2"	4'-8"	2'-8"	TYPE D	
111	BAND ROOM	A	1	2'-6 1/2"	4'-8"	2'-8"	TYPE D	NOTE 5
120	CHORUS ROOM	A	1	2'-6 1/2"	4'-8"	2'-8"	TYPE D	NOTE 5
160	ART ROOM	C	1	2'-6 1/2"	4'-8"	2'-8"	TYPE D	NOTE 5
161	CERAMICS	A	1	2'-6 1/2"	4'-8"	2'-8"	TYPE D	NOTE 5
162	SOCIAL STUDIES CLASSROOM	A	1	2'-6 1/2"	4'-8"	2'-8"	TYPE D	NOTE 5
171-6	OFFICE	D	-	3'-0"	4'-0"	3'-0"	TYPE B	
171-6	OFFICE	D	-	3'-0"	4'-0"	3'-0"	TYPE B	
181	ROTC CLASSROOM	A	1	2'-6 1/2"	4'-8"	2'-8"	TYPE D	NOTE 5
182	ROTC CLASSROOM	C	2	2'-6 1/2"	4'-8"	2'-8"	TYPE D	NOTE 5
205	FACULTY ROOM	C	2	2'-6 1/2"	4'-8"	2'-8"	TYPE D	NOTE 5
207	SOCIAL STUDIES CLASSROOM	C	2	2'-6 1/2"	4'-8"	2'-8"	TYPE D	NOTE 5
208	ENGLISH CLASSROOM	A	2	2'-6 1/2"	4'-8"	2'-8"	TYPE D	NOTE 5
209	SOCIAL STUDIES CLASSROOM	C	2	2'-6 1/2"	4'-8"	2'-8"	TYPE D	NOTE 5
230	FOREIGN LANG. CLASSROOM	C	2	2'-6 1/2"	4'-8"	2'-8"	TYPE D	NOTE 5
234	FOREIGN LANG. CLASSROOM	C	2	2'-6 1/2"	4'-8"	2'-8"	TYPE D	NOTE 5
236	FOREIGN LANG. CLASSROOM	C	2	2'-6 1/2"	4'-8"	2'-8"	TYPE D	NOTE 5
238	SOCIAL STUDIES CLASSROOM	C	2	2'-6 1/2"	4'-8"	2'-8"	TYPE D	NOTE 5
305	I.T. ROOM	C	2	2'-6 1/2"	4'-8"	2'-8"	TYPE D	NOTE 5
307	CLASSROOM	C	2	2'-6 1/2"	4'-8"	2'-8"	TYPE D	NOTE 5
308	MATH CLASSROOM	A	2	2'-6 1/2"	4'-8"	2'-8"	TYPE D	NOTE 5
309	SOCIAL STUDIES CLASSROOM	C	2	2'-6 1/2"	4'-8"	2'-8"	TYPE D	NOTE 5
326	ENGLISH CLASSROOM	C	2	2'-6 1/2"	4'-8"	2'-8"	TYPE D	NOTE 5
328	CLASSROOM	C	2	2'-6 1/2"	4'-8"	2'-8"	TYPE D	NOTE 5
330	ENGLISH CLASSROOM	C	2	2'-6 1/2"	4'-8"	2'-8"	TYPE D	NOTE 5
334	ENGLISH CLASSROOM	A	2	2'-6 1/2"	4'-8"	2'-8"	TYPE D	NOTE 5
336	MATH CLASSROOM	C	2	2'-6 1/2"	4'-8"	2'-8"	TYPE D	NOTE 5
338	ENGLISH CLASSROOM	C	2	2'-6 1/2"	4'-8"	2'-8"	TYPE D	NOTE 5

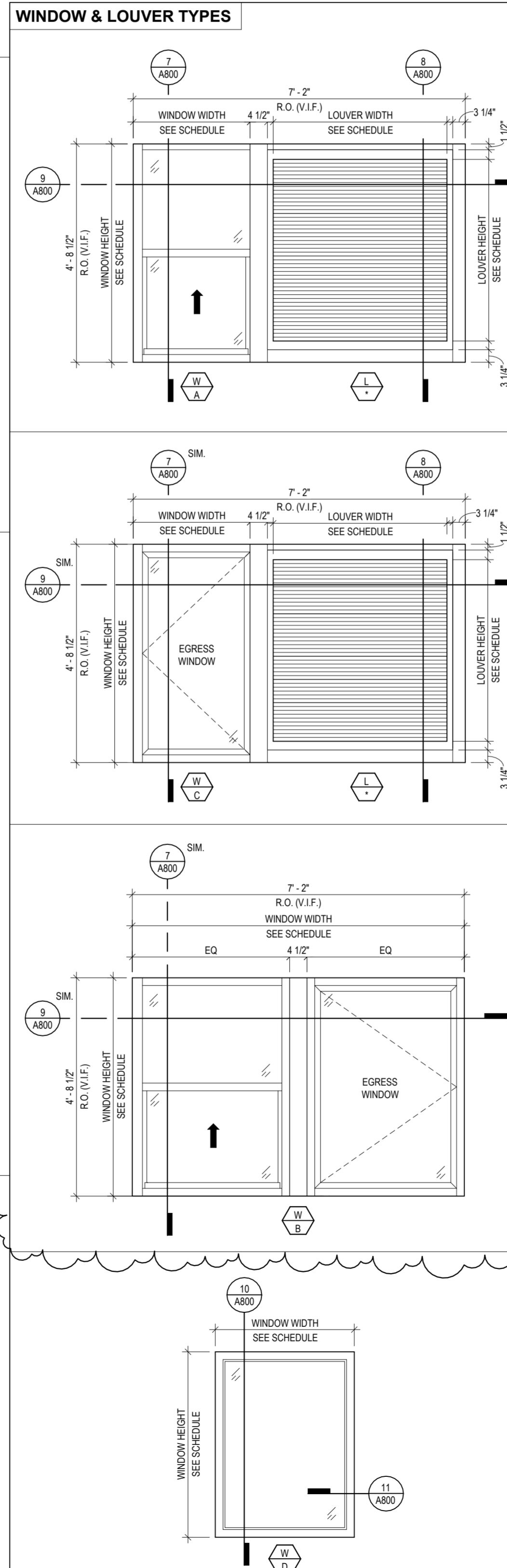

### PARTITION TYPES

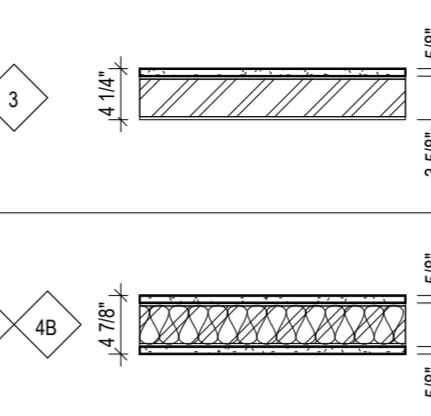

### PARTITION SCHEDULE

MARK	THICKNESS OVERALL	STUD	UL	FIRE RATING	STC	ACOUSTICAL INSULATION	DESCRIPTION
3	4 3/8"	3 5/8"	-	NON RATED	-	No	(1) LAYER OF 5/8" MOISTURE-RESISTANT GYPSUM DRYWALL, ONE SIDE. SCREW ATTACHED @ 12" O.C. WITH STAGGERED VERTICAL JOINTS. (2) 3/8" METAL STUDS @ 16" O.C. SEE SPECIFICATION FOR GAUGE REQUIREMENTS. (3) 1/2" SOUND ATTENUATION BATT INSULATION. (4) 1/2" MOISTURE-RESISTANT GYPSUM BOARD, PROVIDE BACKER BOARD FOR AREAS RECEIVING TILEWORK. REFER TO FINISH PLANS AND ELEVATIONS ON A200 FOR MORE INFORMATION.
4A	5 1/8"	3 5/8"	-	NON RATED	-	No	(1) LAYER OF 5/8" MOISTURE-RESISTANT GYPSUM DRYWALL EACH SIDE. SCREW ATTACHED @ 12" O.C. WITH STAGGERED VERTICAL JOINTS. (2) 3/8" METAL STUDS @ 16" O.C. SEE SPECIFICATION FOR GAUGE REQUIREMENTS. (3) 1/2" SOUND ATTENUATION BATT INSULATION. (4) 1/2" MOISTURE-RESISTANT GYPSUM BOARD, PROVIDE BACKER BOARD FOR AREAS RECEIVING TILEWORK. REFER TO FINISH PLANS AND ELEVATIONS ON A200 FOR MORE INFORMATION.
4B	5 1/8"	3 5/8"	U419	1 HOUR	45	Yes	(1) LAYER OF 5/8" TYPE 'X' GYPSUM DRYWALL EACH SIDE. SCREW ATTACHED @ 12" O.C. WITH STAGGERED VERTICAL JOINTS. (2) 3/8" METAL STUDS @ 16" O.C. SEE SPECIFICATION FOR GAUGE REQUIREMENTS. (3) 1/2" SOUND ATTENUATION BATT INSULATION. (4) 1/2" MOISTURE-RESISTANT GYPSUM BOARD, PROVIDE BACKER BOARD FOR AREAS RECEIVING TILEWORK. REFER TO FINISH PLANS AND ELEVATIONS ON A200 FOR MORE INFORMATION.

### DOOR SCHEDULE

DOOR NO.	LOCATION	ROOM NAME	WIDTH	HEIGHT	THICKNESS	ELEV.	DOOR TYPE	DOOR MATERIAL	FINISH	ELEV.	FRAME TYPE	FINISH	HEAD	JAMB	HARDWARE SET	FIRE RATING	GLAZING	REMARKS
171-1A	DRY STORAGE		3'-0"	7'-0"	1 3/4"	F	WOOD	FACTORY	1	HOLLOW METAL	PAINT	H1	J1	01	-	-	-	
171-2A	TOILET		3'-0"	7'-0"	1 3/4"	F	WOOD	FACTORY	1	HOLLOW METAL	PAINT	H1	J1	02	-	-	-	
171-3A	ICE MAKER		3'-6"	7'-0"	1 3/4"	F	FRP	FACTORY	2	FRP	FACTORY	H2	J2	03	-	-	-	
171-4A	RECEIVING		3'-6"	7'-0"	1 3/4"	F	FRP	FACTORY	2	FRP	FACTORY	H2	J2	04	-	-	-	
171-6A	OFFICE		3'-0"	7'-0"	1 3/4"	N530	WOOD	FACTORY	1	HOLLOW METAL	PAINT	H1	J1	01	-	-	TYPE B	
171-OHD	KITCHEN		12'-0"	8'-0"	1 3/4"	OHD	STEEL	FACTORY	-	ALUM	FACTORY	H3	J3	05	45 min	-	-	MOTORIZED OVERHEAD COILING DOOR
171A	KITCHEN		3'-0"	7'-0"	1 3/4"	N530	WOOD	FACTORY	1	HOLLOW METAL	PAINT	H1	J1	06	45 min	-	TYPE C	
171B	KITCHEN		3'-0"	7'-0"	1 3/4"	N530	WOOD	FACTORY	1	HOLLOW METAL	PAINT	H1	J1	06	45 min	-	TYPE C	

### GENERAL DOOR NOTES

- PROVIDE INTUMESCENT SEALS INCORPORATED INTO STILES OF ALL CATEGORY A FIRE-RATED DOORS.
- PROVIDE SMOKE SEALS INSTALLED ALONG RABBIT (NOT STOPS) OF ALL FIRE-RATED FRAMES.
- UNDERCUT FOR ALL FIRE-RATED DOORS SHALL NOT EXCEED 3/4" AS PER NFPA 80.
- THE CONTRACTOR SHALL FIELD VERIFY ALL DOOR OPENING CONDITIONS PRIOR TO FABRICATION.
- KEY DOOR CORES INTO OWNERS EXISTING MASTER KEYING SYSTEM.
- COORDINATE INSTALLATION OF ELECTRIFIED HARDWARE WITH E-COONTRACTOR AND DOOR ACCESS CONTROL VENDOR PRIOR TO FABRICATION, WHERE REQUIRED.
- REFER TO PARTITION SCHEDULE AND PLANS FOR WALL CONDITIONS. MAINTAIN SEPARATION FROM DISSIMILAR MATERIALS.

### 4 DOOR JAMB DETAIL - J1

SCALE: 1 1/2" = 1'-0"

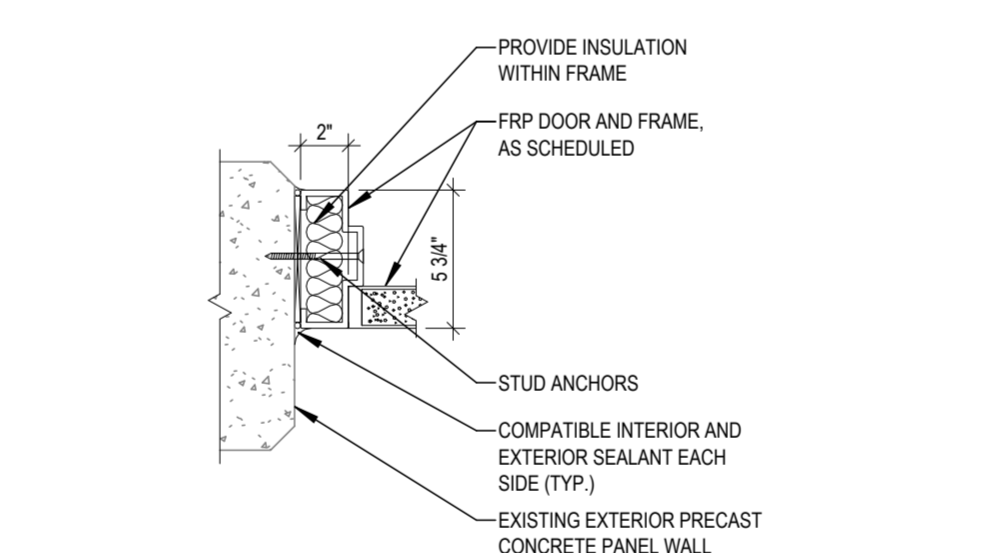

### 5 DOOR JAMB DETAIL - J2

SCALE: 1 1/2" = 1'-0"

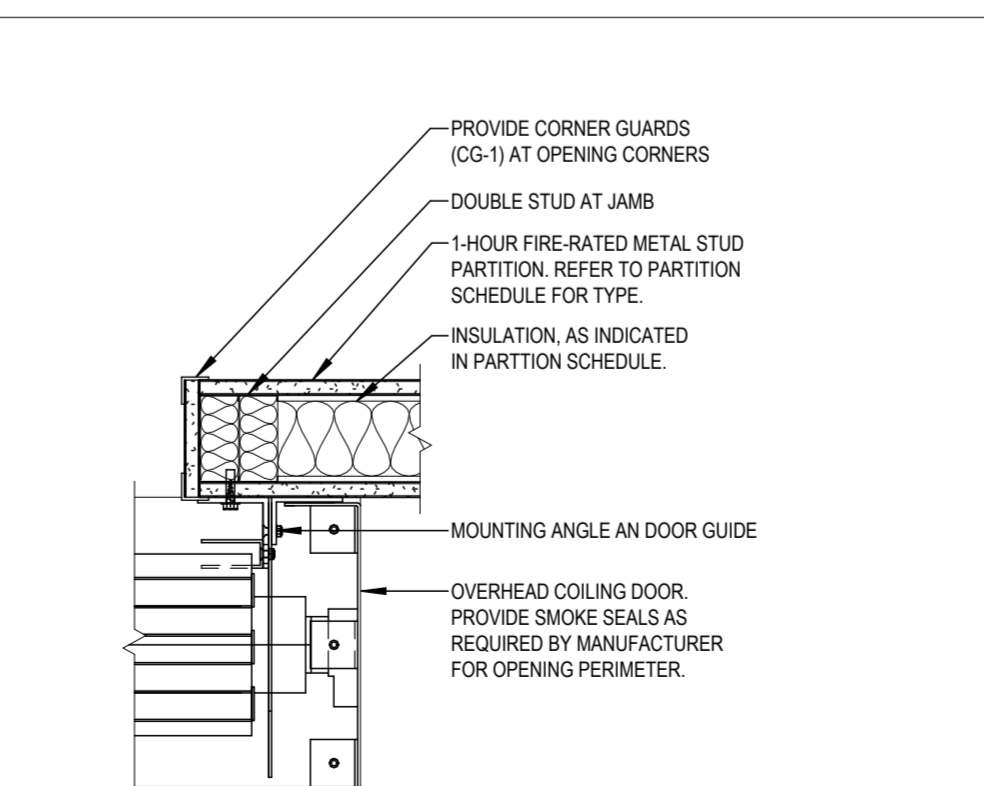

### 6 DOOR JAMB DETAIL - J3

SCALE: 1 1/2" = 1'-0"



### DOOR TYPES

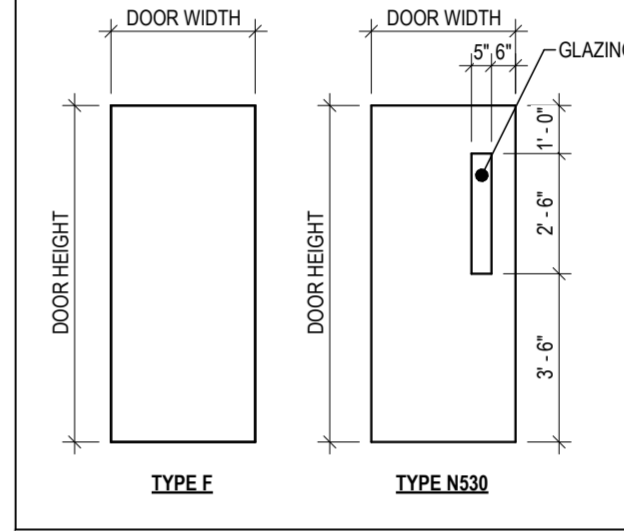

### FRAME TYPES

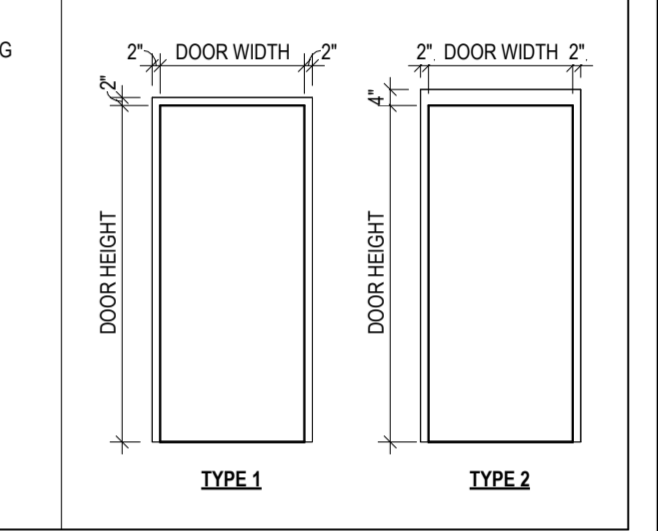

### 1 DOOR HEAD DETAIL - H1

SCALE: 1 1/2" = 1'-0"

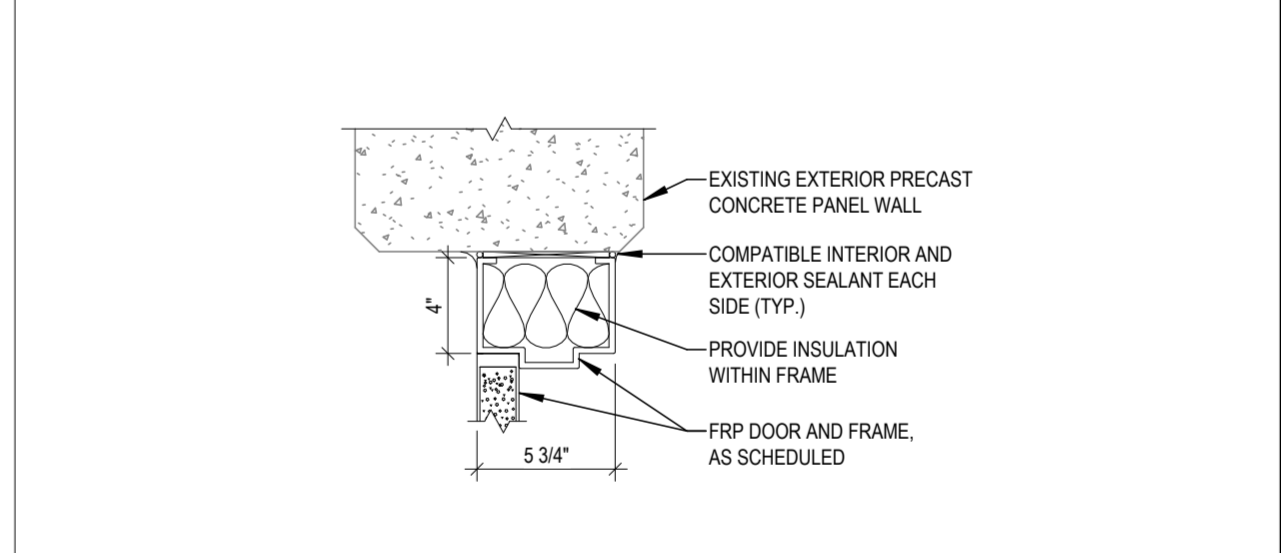

### 2 DOOR HEAD DETAIL - H2

SCALE: 1 1/2" = 1'-0"

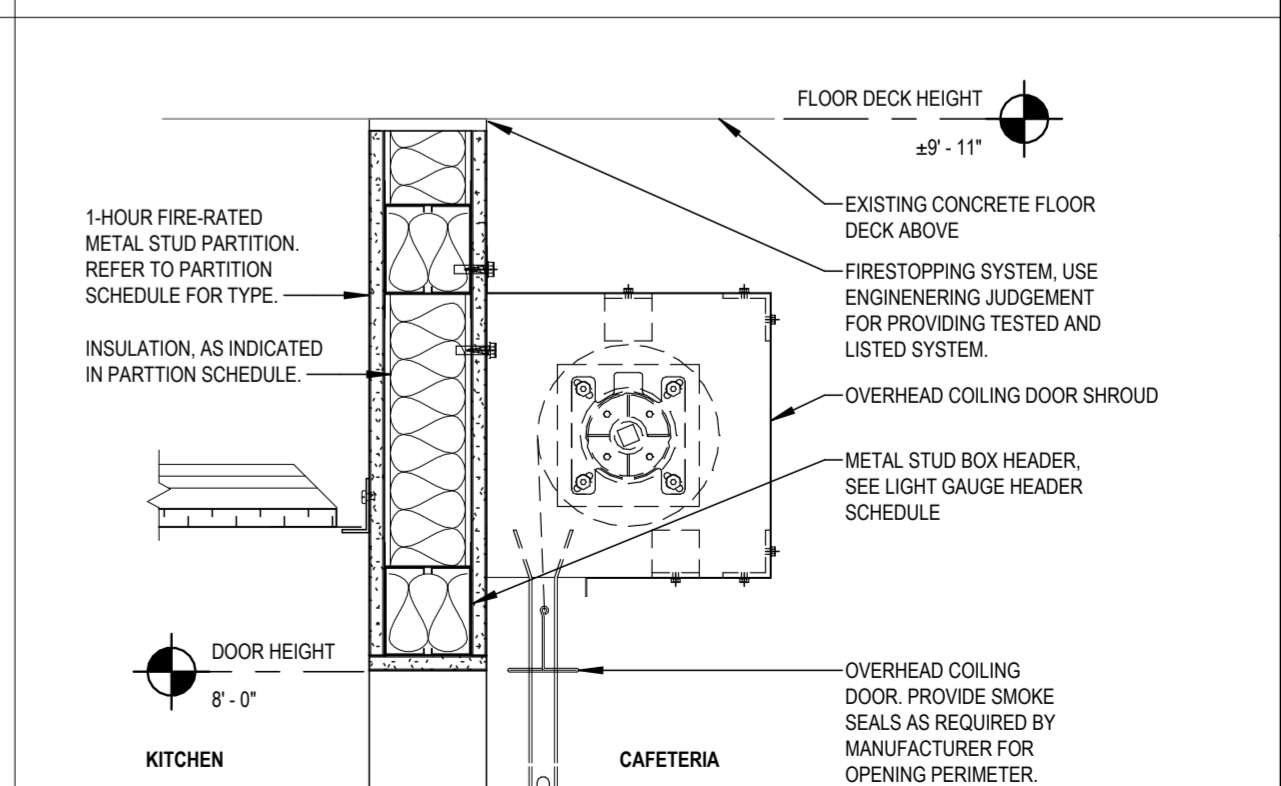

### 3 DOOR HEAD DETAIL - H3

SCALE: 1 1/2" = 1'-0"



### GENERAL PARTITION NOTES

- ALL CMU PARTITIONS SHALL BE 1 HOUR RATED UNLESS SPECIFICALLY INDICATED OTHERWISE.
- ALL PARTITIONS SHALL EXTEND TO THE UNDERSIDE OF DECK (ROOF OR FLOOR) ABOVE UNLESS OTHERWISE NOTED. PARTITIONS WITH AN (1) SHALL STOP 6" ABOVE THE CEILING.
- ALL GYPSUM BOARD LOCATED IN TOILET ROOMS AND JANITOR CLOSETS SHALL BE MOISTURE RESISTANT. THIS APPLIES TO ALL WALLS, CEILING, & SOFFITS. GYPSUM BOARD LOCATED FOR TILE WORK TO BE BACKER BOARD, AS SPECIFIED.
- EXISTING PARTITIONS, EQUIPMENT ETC. TO BE REMOVED ARE INDICATED BY DASHED LINES UNLESS OTHERWISE NOTED.
- PROVIDE THROUGH-PENETRATION AND MEMBRANE FIRESTOPPING SYSTEMS FOR ALL WORK PENETRATING VERTICAL AND HORIZONTAL FIRE-RATED AND SMOKE-RATED ASSEMBLIES. PROVIDE FIRESTOPPING SYSTEMS AT OPENINGS (VOIDS) MADE BY DEMOLITION WORK AT FIRE-RATED AND SMOKE-RATED ASSEMBLIES. PROVIDE JOINT FIRESTOPPING SYSTEMS AT ALL FIRE-RATED INTERSECTIONS AND JUNCTURES. BETWEEN FIRE-RATED ASSEMBLIES, AND BETWEEN FIRE-RATED TO NON-FIRE-RATED ASSEMBLIES. REFERENCE CODE COMPLIANCE (CC) DRAWINGS FOR FIRE-RATED AND SMOKE-RATED ASSEMBLIES AND THEIR LOCATIONS. SEE SPECIFICATIONS FOR ADDITIONAL INFORMATION.
- THE GENERAL CONTRACTOR SHALL BE RESPONSIBLE FOR COORDINATING ALL DUCTWORK WITH THE MECHANICAL CONTRACTOR FOR ALL WALL PENETRATIONS FOR BOTH INTERIOR OR EXTERIOR WALLS. WHETHER INDICATED ON THE ARCH. PLANS OR NOT. THE GENERAL CONTRACTOR SHALL PROVIDE ALL NECESSARY LINTELS IN MASONRY WALLS & HEADERS AND BOX FRAMES IN METAL STUD PARTITIONS.
- PROVIDE IDENTIFICATION MARKINGS FOR FIRE AND SMOKE ASSEMBLY PARTITIONS. SEE 07 0553 FOR REQUIREMENTS.

### GLAZING NOTES

- GLAZING TYPES:
- TYPE B FULLY TEMPERED, SAFETY GLAZING, AS SPECIFIED
  - TYPE C FIRE-RATED, IMPACT SAFETY GLAZING, AS SPECIFIED
  - TYPE D 1" INSULATED, AS SPECIFIED

SED NO. 44-09-01-04-008-019

COPYRIGHT © 2024 - BCA ARCHITECTS & ENGINEERS. WARNING - IT IS A VIOLATION OF THE NEW YORK STATE EDUCATION LAW FOR UNAUTHORIZED ALTERATIONS TO THIS DOCUMENT AS PER ARTICLE 145 AND 147.

**BCA Architects & Engineers**  
Watertown | Ithaca | Saratoga Springs  
Rochester | Troy | Binghamton  
WWW.THEBCAGROUP.COM



HIGHLAND FALLS - FORT MONTGOMERY CSD

ALTERATIONS TO:  
JAMES I. O'NEILL HIGH SCHOOL

HIGHLAND FALLS - ORANGE COUNTY - NEW YORK

REV	DATE	DESCRIPTION
1	01/10/2025	BID ADDENDUM NO. 1

DRAWN BY JAD PROJECT NUMBER 2022-138 PH3

CHECKED BY MCB DATE 12/20/2024

PARTITION, DOOR, AND WINDOW SCHEDULES & DETAILS

BUILDING NUMBER SHEET NUMBER

HS A800