

Submissions

No.	Description	Date
1	ISSUED FOR BID	01/18/2024

© TINKELMAN ARCHITECTURE PLLC | 2023  
 ALL RIGHTS RESERVED. COPY OR REPRODUCTION OF THIS DRAWING OR ANY PORTION THEREOF IS PROHIBITED WITHOUT THE WRITTEN PERMISSION OF THE ARCHITECT. UNLESS OTHERWISE NOTED, ALL TOLERANCES AND DIMENSIONS SHALL BE AS SHOWN. THE ARCHITECT'S RESPONSIBILITY IS LIMITED TO THE DESIGN AND CONSTRUCTION OF THE WORK SHOWN ON THIS DRAWING. THE ARCHITECT IS NOT RESPONSIBLE FOR THE DESIGN OR CONSTRUCTION OF ANY OTHER WORK SHOWN ON THIS DRAWING. THE ARCHITECT'S LIABILITY IS LIMITED TO THE DESIGN AND CONSTRUCTION OF THE WORK SHOWN ON THIS DRAWING. THE ARCHITECT IS NOT RESPONSIBLE FOR THE DESIGN OR CONSTRUCTION OF ANY OTHER WORK SHOWN ON THIS DRAWING.



**FIRST FLOOR  
 OVERALL PLAN  
 - SELECTIVE  
 DEMOLITION**

Proj. No. C2349.00  
 Date 01/18/2024

**A-101**

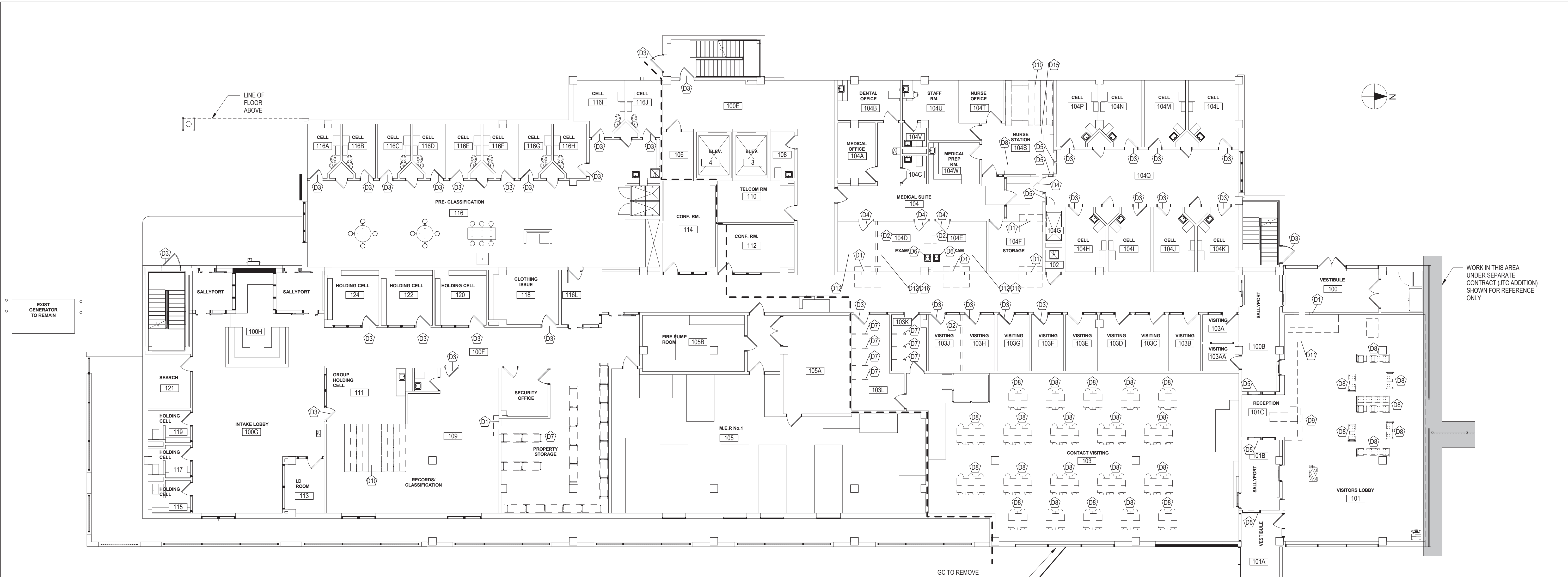

1 FIRST FLOOR PLAN - SELECTIVE DEMOLITION  
 3/32" = 1'-0"

GC TO REMOVE BUILDING MOUNTED "JAIL" LETTERING. PATCH TO MATCH EXISTING.

**DEMOLITION LEGEND**

	WALLS TO REMAIN
	ITEMS TO BE REMOVED
	DEMO AREA NOTE TAG

**SELECTIVE DEMOLITION GENERAL NOTES**

1. THE CONTRACTOR SHALL COORDINATE ALL REMOVALS WITH THE PLANS NEEDED FOR NEW CONSTRUCTION WORK, AND REMOVE ALL COMPONENTS AND MATERIALS NECESSARY TO ACCOMMODATE THE NEW WORK. ALL ITEMS SCHEDULED FOR REMOVAL SHALL BE FIRST CONFIRMED FOR POTENTIAL SALVAGE AND TURNED OVER TO OWNER, AND UPON REFUSAL, PROPERLY DISPOSED OFF SITE.
2. ALL REQUIRED REMOVAL WORK SHALL INCLUDE REMOVAL OF ANY AND ALL ANCHORING SYSTEMS INCLUDING OBJECTS EMBEDDED INTO EXISTING WALLS. REFER TO THE RESPECTIVE MEP PRIME CONTRACTOR TO COORDINATE THE DEMOLITION WORK AND THE MEP DRAWINGS FOR ADDITIONAL REMOVAL INFORMATION.
3. THE GENERAL CONTRACTOR SHALL PROVIDE TEMPORARY SHORING AS NECESSARY AT ALL AREAS OF WALL REMOVAL AND NEW WALL PENETRATIONS. DRILL CORNERS OF ALL NEW SAWCUT OPENING PRIOR TO SAW CUTTING, TO PREVENT CUTTING INTO CONSTRUCTION TO REMAIN.
4. GRIND FLOOR SMOOTH TO MATCH EXISTING ADJACENT FLOOR FINISH ELEVATION FOR CLEAN FINISH. UNDER ANY MASONRY WALLS TO BE FULLY REMOVED.

**DEMOLITION SCOPE NOTES**

- D1 THE GENERAL CONTRACTOR TO REMOVE PORTION OF CMU WALL TO ACCOMMODATE NEW DOOR / FRAME. COORDINATE WITH PRIME CONTRACTORS AND DRAWINGS MEP DRAWINGS FOR ADDITIONAL SCOPE.
- D2 THE GENERAL CONTRACTOR TO REMOVE CMU WALL IN ITS ENTIRETY, PREP FLOORING FOR NEW FINISH. COORDINATE WITH MEP PRIME CONTRACTOR AND MEP DRAWINGS FOR ADDITIONAL SCOPE.
- D3 THE GENERAL CONTRACTOR TO MODIFY EXISTING DOOR HARDWARE / CONTROLS FOR EGRESS COMPLIANCE. COORDINATE WITH MEP PRIME CONTRACTOR AND DRAWINGS FOR ADDITIONAL INFORMATION.
- D4 THE GENERAL CONTRACTOR TO REMOVE EXISTING DOOR & FRAME, IN ITS ENTIRETY, INCLUDING EXISTING ANCHORS TO CMU WALL. PREP FOR NEW CONSTRUCTION.
- D5 THE GENERAL CONTRACTOR TO REMOVE EXISTING WINDOW & FRAME, IN ITS ENTIRETY, INCLUDING ANCHORS TO CMU WALL. PREP FOR NEW CONSTRUCTION.
- D6 THE PLUMBING PRIME CONTRACTOR IS TO REMOVE PLUMBING FIXTURE / EQUIPMENT TO ACCOMMODATE NEW WORK SCOPE. COORDINATE WITH MEP DRAWINGS FOR ADDITIONAL SCOPE.
- D7 THE GENERAL CONTRACTOR IS TO REMOVE & DISCARD OF THE EXISTING STORAGE BUILT-INS.
- D8 THE GENERAL CONTRACTOR IS TO REMOVE & DISCARD EXISTING BUILT-IN SEATING / TABLES, IN THEIR ENTIRETY INCLUDING ATTACHMENTS TO FLOOR. PREP FOR NEW FINISH WORK.
- D9 THE GENERAL CONTRACTOR IS TO REMOVE & DISCARD EXISTING BUILT-IN SECURITY STATION. COORDINATE WITH PRIME CONTRACTORS AND COORDINATE WITH THE MEP DRAWINGS FOR ADDITIONAL WORK SCOPE.
- D10 THE GENERAL CONTRACTOR IS TO REMOVE & DISCARD EXISTING FILE SYSTEM, INCLUDING BUILT-UP SUBFLOOR, COMPLETE.
- D11 THE PLUMBING CONTRACTOR TO SAW CUT EXISTING FINISH FLOOR AND CONCRETE SLAB. THE PRIME CONTRACTOR IS TO MAKE EVERY EFFORT TO MINIMIZE THE WIDTH OF THE TRENCH WHILE MEETING THE SPECIFICATIONS. SEE MEP DRAWINGS FOR MORE INFORMATION.
- D12 THE GENERAL CONTRACTOR TO REMOVE EXISTING FINISH FLOORING AND CONCRETE TO ACCESS EXISTING SANITARY PIPING IN NEW RESTROOMS. SEE MEP DRAWINGS FOR MORE INFORMATION.
- D13 THE GENERAL CONTRACTOR TO REMOVE CARPET TILE AND TRANSITION PIECE IN ITS ENTIRETY AND DISCARD. PREPARE FLOOR IN ACCORDANCE WITH MANUFACTURERS SPECIFICATIONS.
- D14 THE GENERAL CONTRACTOR TO MODIFY EXISTING CEILING GRID FOR NEW STAFF BATHROOM. COORDINATE WITH NEW WORK PLANS.
- D15 THE GENERAL CONTRACTOR TO MODIFY EXISTING CEILING GRID FOR NEW LAUNDRY. COORDINATE WITH NEW WORK PLANS.
- D16 THE GENERAL CONTRACTOR TO REMOVE EXISTING CEILING IN ITS ENTIRETY AND PREP FOR NEW GWB CEILING. COORDINATE WITH NEW WORK PLAN.

