

SIGN SCHEDULE			
DESIGNATION #	DESCRIPTION	SIZE (H x W)	QUANTITY
1	STAFF ENTRANCE	12" x 24"	1
2	GUEST ENTRANCE	12" x 24"	6
3U	ARROW SYMBOL UP	8" x 15"	1
3L	ARROW SYMBOL LEFT	8" x 15"	2
3R	ARROW SYMBOL RIGHT	8" x 15"	3
4	NO PARKING ANYTIME (MUTCD R8-3)	18" x 9"	1
5	RESERVED PARKING (MUTCD R7-8)	18" x 9"	2
6	DELIVERIES	12" x 24"	3

- NOTES:
- IMPROVEMENTS SHOWN HEREIN ASSUME JTC PROJECT HAS COMPLETED: 1984 JAIL DEMOLITION, ALL PARKING IMPROVEMENTS ALONG NORTH HAMILTON STREET, AND DECORATIVE FENCE BETWEEN JTC & HOMELESS SHELTER.
 - PRIOR TO REMOVAL OF THE TEMPORARY INMATE HOUSING UNITS, DELIVERIES TO THE HOMELESS SHELTER WILL BE COMPLETED VIA THE GUEST ENTRANCE.
 - CONTRACTOR SHALL COORDINATE WITH JTC CONSTRUCTION MANAGEMENT TO MINIMIZE RE-WORK TO THE MAXIMUM EXTENT POSSIBLE.
 - CONTRACTOR TO INSTALL ALL PROPOSED SIGN POSTS AND SIGNS. SIGNS TO BE PROVIDED BY OWNER.

FOR INFORMATION ONLY, TO BE COMPLETED UNDER SEPARATE CONTRACT

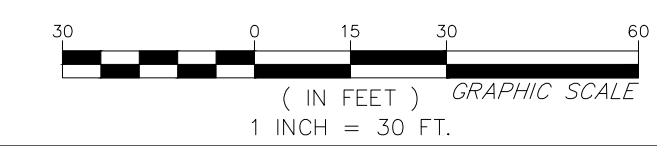
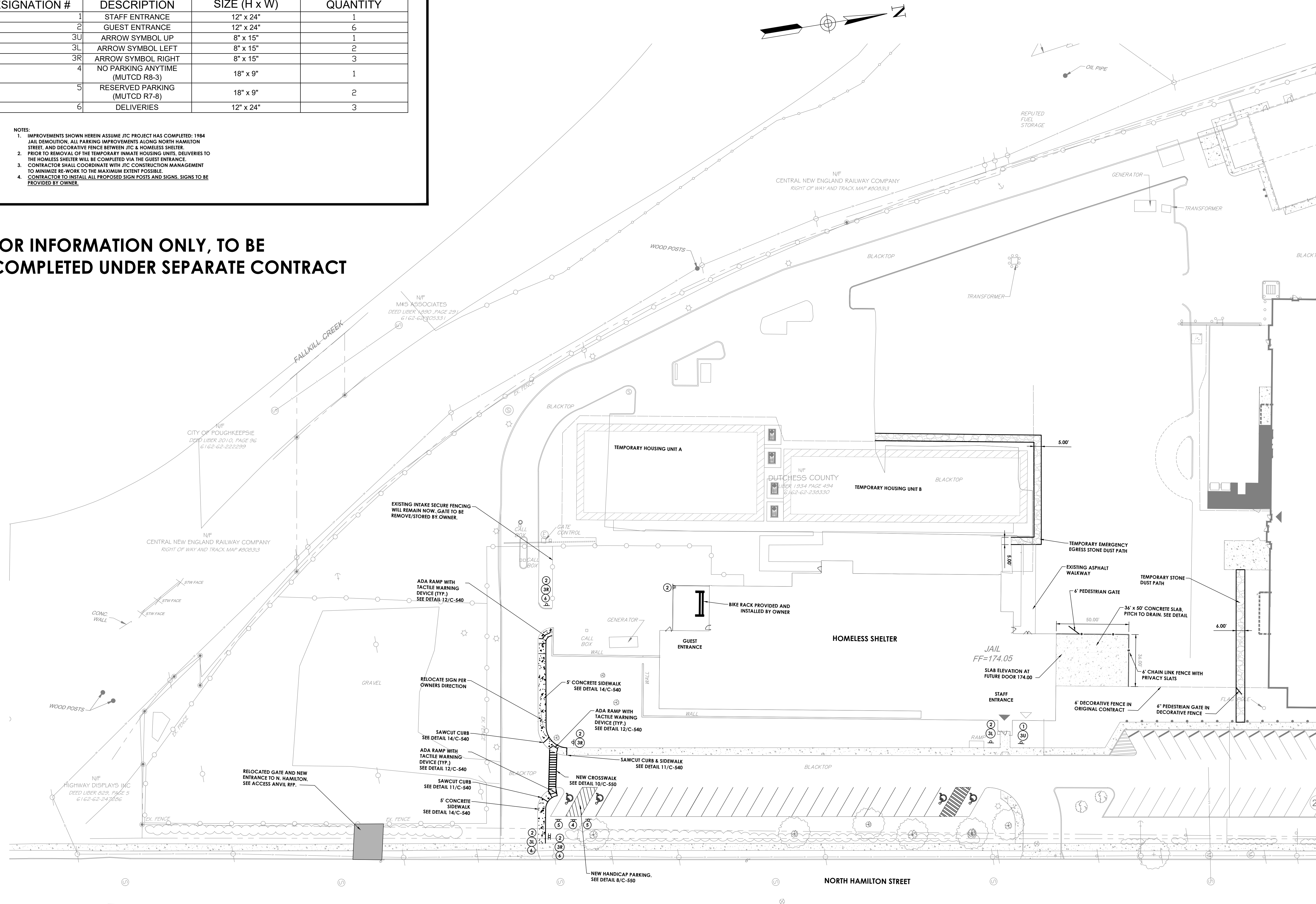

Submissions

No.	Description	Date

© TINKELMAN ARCHITECTURE PLLC | 2023
ALL RIGHTS RESERVED. NO COPY OR REPRODUCTION OF THIS DRAWING OR ANY PART THEREOF IS PERMITTED WITHOUT THE WRITTEN PERMISSION OF THE ARCHITECT. UNAUTHORIZED ALTERATION OR ADDITION TO OR REMOVAL THEREOF SHALL BE CONSIDERED A VIOLATION OF THE PROFESSIONAL ETHICS OF ARCHITECTS AS ENFORCED BY THE NEW YORK STATE EDUCATION LAW.

Professional Seal

Drawing Name: S:\Projects\Tinkelman_GenArch\1995 DC Jail\CH\ACAD\Site\DCI_C200_Site.dwg Date last modified: 1/15/2024 1:51 PM Date last plotted: 1/15/2024 2:00 PM Plotted By: Kyle Southern

12/16/2023 10:30:35 AM